

**Sampling Date: September 1, 2020**  
**Submission Date: September 14, 2020**

# **Water Sampling Report**

## **Lakeview Presbyterian School**

**5915 Louis XIV Street, New Orleans, LA 70124**  
**(MMG Job # 3921 LDH-08)**



Prepared for:

Caryn Benjamin  
LDH-OPH, Engineering Services  
628 N. Fourth Street  
P.O. Box 4489  
Baton Rouge, LA 70821



By:



Materials Management Group, Inc.  
2401 Westbend Parkway, Suite 3010  
New Orleans, LA 70114

## Water Sampling Report (Sampling Date: 9/1/2020)

Lakeview Presbyterian Weekday School  
5915 Louis XIV Street, New Orleans, LA 70124

Report Date: 9/14/2020  
MMG Job # 3921 LDH 08

### Table of Contents

Table of Contents .....	1
1.0 Introduction.....	2
2.0 Summary of Activities .....	2
2.1 MMG Personnel .....	2
2.2 Methodology .....	2
2.3 Field Activities .....	3
3.0 Analytical Results.....	3
4.0 Recommendation(s) from LDH-OPH.....	5
5.0 Signature of Principal .....	5
Appendices .....	5
Appendix A:       Sampling Maps	
Appendix B:       Laboratory Report and Chain of Custody Documentation	
Appendix C:       Laboratory Accreditations and Certifications	

## **1.0 Introduction**

Materials Management Group, Inc. (MMG) was retained by the Louisiana Department of Health – Office of Public Health (LDH-OPH) to conduct water sampling for the potential presence and concentration of lead in drinking water at primary schools and childcare facilities throughout Louisiana. MMG's scope of work includes testing sources of water used for consumption in a given school or childcare facility as determined by representatives of LDH-OPH. This report summarizes water testing performed Lakeview Presbyterian Weekday School, 5915 Louis XIV Street, New Orleans, LA 70124 (School).

MMG personnel Erin LeCompte and Braelin Carter performed the initial facility assessment at the School on June 25, 2020. A water sampling plan was submitted to LDH-OPH on July 13, 2020 and approved on July 14, 2020. Water sampling was performed at the School on September 1, 2020 by MMG staff.

## **2.0 Summary of Activities**

### **2.1 MMG Personnel**

Multiple MMG personnel participated in this water sampling assessment and investigation. All MMG personnel that conducted water sampling on September 1, 2020 are LDEQ-accredited Lead Inspectors and Lead Risk Assessors. Table 2.1 below summarizes MMG personnel who conducted water sampling at the School and includes their certification information.

**Table 2.1 MMG Personnel Accreditation Information Summary**

<b>MMG Personnel</b>	<b>Accreditation Type</b>	<b>Certification Number</b>	<b>Date of Expiration</b>
<b>Erin LeCompte</b>	Lead Inspector	OI217986	10/07/2020
	Lead Risk Assessor	OR217986	10/07/2020
<b>Sue-Claire Lichtveld</b>	Lead Inspector	JI210196	07/09/2021
	Lead Risk Assessor	JR210196	07/10/2021

### **2.2 Methodology**

The MMG team utilized the water sampling methodology described in the guidance document, "3 T's for Reducing Lead in Drinking Water in Schools and Child Care Facilities: A Training, Testing, and Taking Action Approach", authored by the Environmental Protection Agency (EPA), Office of Ground Water and Drinking Water.

The EPA recommends schools and childcare facilities use a 2-step sampling procedure which specifies the collection of two (2) water samples per fixture. The "1<sup>st</sup> Draw" sample is taken from the fixture once water has been sitting stagnant

## Water Sampling Report (Sampling Date: 9/1/2020)

Lakeview Presbyterian Weekday School  
5915 Louis XIV Street, New Orleans, LA 70124

Report Date: 9/14/2020  
MMG Job # 3921 LDH 08

in the fixture for no less than 8 hours and no more than 18 hours. The “2<sup>nd</sup> Draw” sample is then collected from the same fixture after the fixture has been “flushed” for a pre-determined length of time. “Flushing” a fixture is accomplished by running water through the fixture at a moderate flow rate for 30 seconds (in the case of faucets and bubblers) or 15 minutes (in the case of water coolers or other fixtures which include a holding tank or similar water storage/refrigeration component). Using the “2-draw” method of water sampling described in the “3 T’s” document is meant to ensure that the water samples collected at a given facility are representative of water quality and usage under “normal” conditions.

All water samples were collected in individual 250 mL plastic bottles, with preservatives, provided by the testing laboratory.

### 2.3 Field Activities

MMG performed all water sampling activities at the School on September 1, 2020 beginning at approximately 6:30 AM. Samples were collected from all fixtures pre-approved by LDH. See Appendix A: Sampling Maps for illustrated locations of each sample.

After collection, water samples were transported via courier to Waypoint Analytical located at 5041 Taravella Road, Marrero, LA 70072. All samples were analyzed for lead concentration using the EPA 200.8 Method with ICP-MS. The laboratory certification issued for Waypoint Analytical by the Louisiana Department of Health (LDH) is included in Appendix C.

## 3.0 Analytical Results

Table 3.1 summarizes the analytical results for the water samples taken by MMG at Lakeview Presbyterian Weekday School, located at 5915 Louis SIX Street, New Orleans, LA 70124 on September 1, 2020. The table also compares the results to the LDH-OPH lead action level of 15 parts per billion, which is equivalent to 15 µg/L. The complete analytical reports for all water samples taken over the course of the investigation, including chain-of-custody documentation, can be found in Appendix B.

**Table 3.1 Water Sampling Results for Loyola University  
Whelan Children’s Center**

Sample ID	Sample Location	Description	Result (µg/L)	LDH-OPH Lead Action Level (µg/L)	Exceedance? (Yes/No)
LPS-1Rm4-F1-D1	Room 4 Classroom Sink	First Draw	1.69	15	No
LPS-1Rm4-F1-D2	Room 4 Classroom Sink	Second Draw	1.97	15	No
LPS-1Rm5-F1-D1	Room 5 Classroom	First Draw	1.74	15	No

# Water Sampling Report (Sampling Date: 9/1/2020)

**Lakeview Presbyterian Weekday School**  
**5915 Louis XIV Street, New Orleans, LA 70124**

**Report Date: 9/14/2020**  
**MMG Job # 3921 LDH 08**

Sample ID	Sample Location	Description	Result (µg/L)	LDH-OPH Lead Action Level (µg/L)	Exceedance? (Yes/No)
	Sink				
LPS-1Rm5-F1-D2	Room 5 Classroom Sink	Second Draw	1.77	15	No
LPS-1Rm6-F1-D1	Room 6 Classroom Sink	First Draw	1.54	15	No
LPS-1Rm6-F1-D2	Room 6 Classroom Sink	Second Draw	2.29	15	No
LPS-1Rm7-F1-D1	Room 7 Classroom Sink	First Draw	1.48	15	No
LPS-1Rm7-F1-D2	Room 7 Classroom Sink	Second Draw	1.60	15	No
LPS-1H1BA1-F1-D1	Hallway Bathroom 1, Men's	First Draw	1.41	15	No
LPS-1H1BA1-F1-D2	Hallway Men's Bathroom Sink	Second Draw	1.22	15	No
LPS-1H1BA2-F1-D1	Hallway Men's Bathroom Sink	First Draw	1.86	15	No
LPS-1H1BA2-F1-D2	Hallway Women's Bathroom Sink	Second Draw	1.56	15	No
LPS-1Rm8-F1-D1	Room 8 Classroom Sink	First Draw	1.74	15	No
LPS-1Rm8-F1-D2	Room 8 Classroom Sink	Second Draw	1.96	15	No
LPS-1 Rm9-F1-D1	Room 9 Classroom Sink	First Draw	1.73	15	No
LPS-1 Rm9-F1-D2	Room 9 Classroom Sink	Second Draw	1.70	15	No
LPS-1Rm10-F1-D1	Room 10 Classroom Sink	First Draw	2.25	15	No
LPS-1Rm10-F1-D2	Room 10 Classroom Sink	Second Draw	1.95	15	No
LPS-1Rm1BA1-F1-D1	Room 1 Foyer Bathroom Sink	First Draw	1.51	15	No
LPS-1Rm1BA1-F1-D2	Room 1 Foyer Bathroom Sink	Second Draw	1.58	15	No
LPS-1Rm3-F1-D1	Room 3 Kitchen Handwash Sink	First Draw	2.49	15	No
LPS-1Rm3-F1-D2	Room 3 Kitchen Handwash Sink	Second Draw	1.48	15	No
LPS-1Rm3-F2-D1	Room 3 Kitchen Tri-Basin Sink	First Draw	1.93	15	No
LPS-1Rm3-F2-D2	Room 3 Kitchen Tri-Basin Sink	Second Draw	1.36	15	No
LPS-1Rm3BA1-F1-D1	Room 3 Kitchen Bathroom Sink	First Draw	1.27	15	No
LPS-1Rm3BA1-F1-D2	Room 3 Kitchen Bathroom Sink	Second Draw	14.0	15	No

## **4.0 Recommendation(s) from LDH-OPH**

At the request of LDH-OPH, MMG has included the following recommendation(s) in this report:

*The Louisiana Department of Health recommends that Facilities should not use water from hose bibbs for potable purposes such as consumption, food/drink preparation, and cooking.*

*The Louisiana Department of Health recommends to not use the fixture (Kitchen Bathroom sink [Rm3BA1-F1]) that had the high lead level (14 ug/L) for drinking, food/drink preparation, and cooking. LDH recommends using signage at the fixture to specify "hand washing only".*

## **5.0 Signature of Principal**



**C. Paul Lo, ScD**

Principal Environmental Health Scientist & LDEQ Lead Project Designer

## **Appendices**

- Appendix A:        Sampling Maps**
- Appendix B:        Laboratory Report and Chain of Custody Documentation**
- Appendix C:        Laboratory Accreditations and Certifications**

**Water Sampling Report (Sampling Date: 9/1/2020)**

**Lakeview Presbyterian Weekday School  
5915 Louis XIV Street, New Orleans, LA 70124**

**Report Date: 9/14/2020  
MMG Job # 3921 LDH 08**

---

**Appendix A: Sampling Maps**



Lakeview Presbyterian  
School

C

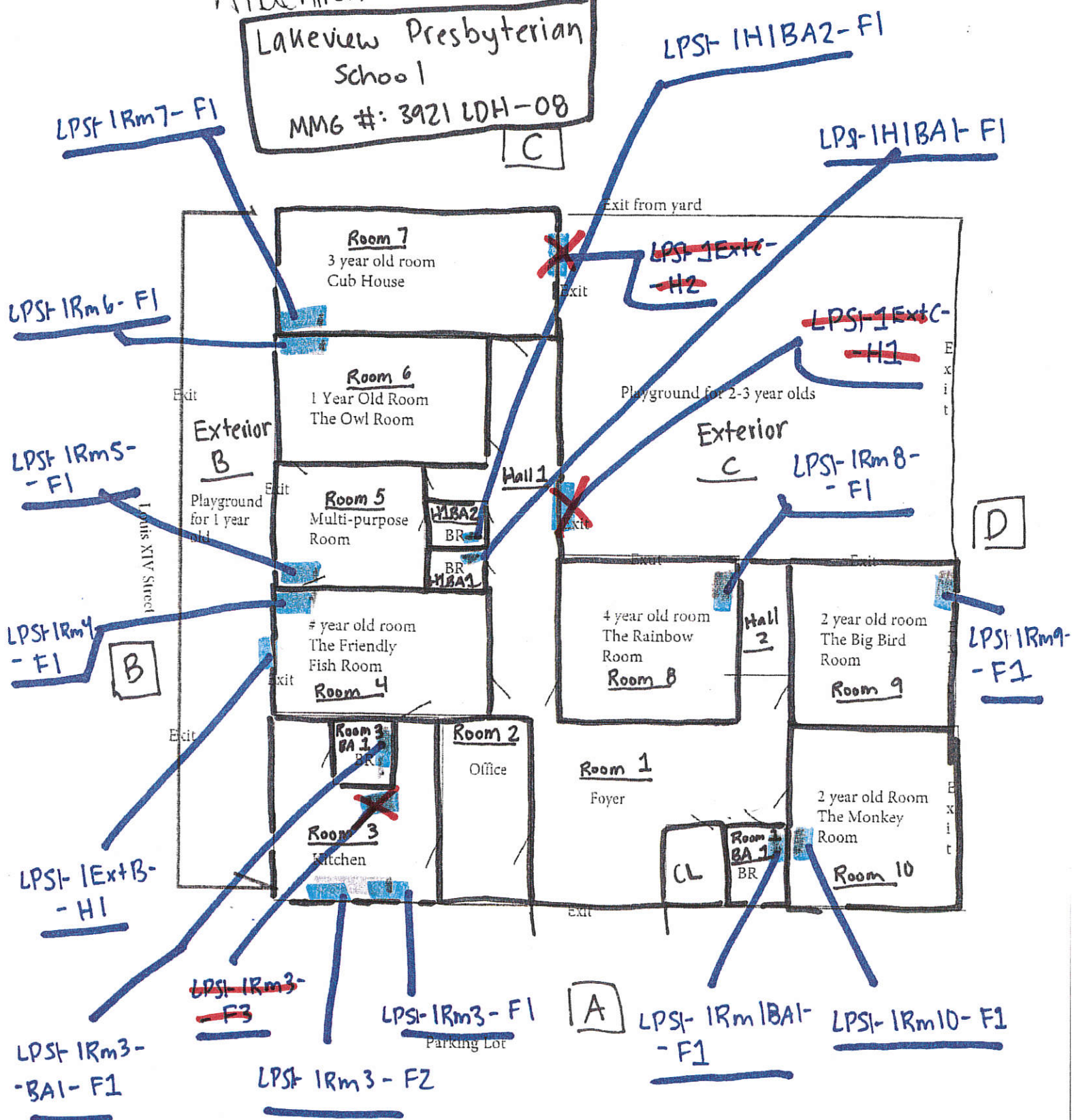



**Water Sampling Report (Sampling Date: 9/1/2020)**

**Lakeview Presbyterian Weekday School  
5915 Louis XIV Street, New Orleans, LA 70124**

**Report Date: 9/14/2020  
MMG Job # 3921 LDH 08**

**Appendix B: Laboratory Report and Chain of Custody  
Documentation**

9/9/2020

Materials Management Group, Inc.  
Ms. Braelin Carter  
2401 Westbend Parkway  
Suite 3010  
New Orleans, LA, 701141

Ref: Report Number: 20-245-0008  
Project Description: H2O in Lead at Lakeview Presbyterian Wee  
5915 Louis XIV Street, New Orleans, LA 7  
3921LDH-08

Dear Ms. Braelin Carter:

Waypoint Analytical Louisiana, Inc. received sample(s) on 9/1/2020 for the analyses presented in the following report. The above referenced project has been analyzed per your instructions. Unless otherwise noted, the analyses were performed in our laboratory in accordance with Standard Methods, The Solid Waste Manual SW-846, EPA Methods for Chemical Analysis of Water and Wastes and /or 40 CFR part 136.

Certain parameters (chlorine, pH, dissolved oxygen, sulfite...) are required to be analyzed within 15 minutes of sampling. Usually, but not always, any field parameter analyzed at the laboratory is outside of this holding time. Refer to sample analysis time for confirmation of holding time compliance. Analyses reported which indicate "Field" for these parameters were analyzed by the client in the field. Results for solid samples are reported on an as received or "wet weight" basis unless otherwise specified.

The analytical data has been validated using standard quality control measures performed as required by the analytical method. Quality Assurance, method validations, instrumentation maintenance and calibration for all parameters (NELAP and non-NELAP) were performed in accordance with guidelines established by the USEPA (including 40 CFR 136 Method Update Rule May 2012) and NELAC unless otherwise indicated. Any parameter for which the laboratory is not officially NELAP accredited is indicated by a '~' symbol. These are not included in the scope because NELAP accreditation is either not available or has not been applied for. Additional certifications may be held/are available for parameters, where NELAP accreditation is not required or applicable. A full list of certifications is available upon request.

All quality control measures undertaken in accordance with Waypoint Analytical Louisiana, Inc. CompQAP990807A and revisions under the terms of the Louisiana Environmental Laboratory Accreditation Program (Certificate #02041) are within acceptance ranges established in that document with the exception of the items indicated and/or discussed in a Case Narrative.

The results are shown on the attached analysis sheet(s). Be aware that the time analyzed for certain samples (e.g. - BOD, CBOD, etc.) refer to the time the sample batch was begun and not necessarily to the time an individual sample was begun. Thank you for allowing Waypoint Analytical Louisiana, Inc. to serve you. Should I be of further assistance, if you have any questions or need additional information please contact me or client services.

Sincerely,



Anthony J. Albert  
Laboratory Director

*Laboratory's liability in any claim relating to analyses performed shall be limited to, at laboratory's option, repeating the analysis in question at laboratory's expense, or the refund of the charges paid for performance of said analysis. This report may be reproduced in full only with the written permission of the laboratory and/or the entity to which it is addressed. Results contained herein relate only to the sample(s) submitted to the laboratory.*



## Certification Summary

### Laboratory ID: WP MLA: Waypoint Analytical Louisiana, Inc., Marrero, LA

State	Program	Lab ID	Expiration Date
Georgia	State Program	02041	06/30/2021
Louisiana	State Program - NELAP	02041	06/30/2021

### Laboratory ID: WP MTN: Waypoint Analytical, LLC., Memphis, TN

State	Program	Lab ID	Expiration Date
Alabama	State Program	40750	02/28/2021
Arkansas	State Program	88-0650	02/07/2021
California	State Program	2904	05/10/2020
Florida	State Program - NELAP	E871157	06/30/2021
Georgia	State Program	C044	02/18/2023
Georgia	State Program	04015	06/30/2021
Illinois	State Program - NELAP	200078	10/10/2020
Kentucky	State Program	80215	06/30/2021
Kentucky	State Program	KY90047	12/31/2020
Louisiana	State Program - NELAP	LA037	12/31/2020
Louisiana	State Program - NELAP	04015	06/30/2021
Mississippi	State Program	MS	02/11/2023
North Carolina	State Program	415	12/31/2020
Oklahoma	State Program	9311	08/31/2021
Pennsylvania	State Program - NELAP	68-03195	05/31/2021
South Carolina	State Program	84002	06/30/2021
South Carolina	State Program	84002	06/30/2021
Tennessee	State Program	02027	02/11/2023
Tennessee	A2LA ISO 17025:2017	4313.01	10/31/2021
Texas	State Program - NELAP	T104704180	09/30/2020
Virginia	State Program	00106	06/30/2021
Virginia	State Program - NELAP	460181	09/14/2020

### Sample Summary Table

**Report Number:** 20-245-0008  
**Client Project Description:** H2O in Lead at Lakeview Presbyterian Wee  
5915 Louis XIV Street, New Orleans, LA 7  
3921LDH-08

Lab No	Client Sample ID	Matrix	Date Collected	Date Received	Method	Lab ID
79450	LPS-1 Rm4-F1-D1	Aqueous	09/01/2020 06:50	09/01/2020	EPA-200.8 (DW)	WP MTN
79451	LPS-1 Rm4-F1-D2	Aqueous	09/01/2020 06:59	09/01/2020	EPA-200.8 (DW)	WP MTN
79452	LPS-1 Rm5-F1-D1	Aqueous	09/01/2020 06:48	09/01/2020	EPA-200.8 (DW)	WP MTN
79453	LPS-1 Rm5-F1-D2	Aqueous	09/01/2020 06:57	09/01/2020	EPA-200.8 (DW)	WP MTN
79454	LPS-1 Rm6-F1-D1	Aqueous	09/01/2020 06:47	09/01/2020	EPA-200.8 (DW)	WP MTN
79455	LPS-1 Rm6-F1-D2	Aqueous	09/01/2020 06:56	09/01/2020	EPA-200.8 (DW)	WP MTN
79456	LPS-1 Rm7-F1-D1	Aqueous	09/01/2020 06:46	09/01/2020	EPA-200.8 (DW)	WP MTN
79457	LPS-1 Rm7-F1-D2	Aqueous	09/01/2020 06:55	09/01/2020	EPA-200.8 (DW)	WP MTN
79458	LPS-1 1H1BA1-F1-D1	Aqueous	09/01/2020 06:49	09/01/2020	EPA-200.8 (DW)	WP MTN
79459	LPS-1 1H1BA1-F1-D2	Aqueous	09/01/2020 07:00	09/01/2020	EPA-200.8 (DW)	WP MTN
79460	LPS-1 1H1BA2-F1-D1	Aqueous	09/01/2020 06:48	09/01/2020	EPA-200.8 (DW)	WP MTN
79461	LPS-1 1H1BA2-F1-D2	Aqueous	09/01/2020 06:59	09/01/2020	EPA-200.8 (DW)	WP MTN
79462	LPS-1 Rm8-F1-D1	Aqueous	09/01/2020 06:49	09/01/2020	EPA-200.8 (DW)	WP MTN
79463	LPS-1 Rm8-F1-D2	Aqueous	09/01/2020 06:58	09/01/2020	EPA-200.8 (DW)	WP MTN
79464	LPS-1 Rm9-F1-D1	Aqueous	09/01/2020 06:48	09/01/2020	EPA-200.8 (DW)	WP MTN
79465	LPS-1 Rm9-F1-D2	Aqueous	09/01/2020 06:57	09/01/2020	EPA-200.8 (DW)	WP MTN
79466	LPS-1 Rm10-F1-D1	Aqueous	09/01/2020 06:47	09/01/2020	EPA-200.8 (DW)	WP MTN
79467	LPS-1 Rm10-F1-D2	Aqueous	09/01/2020 06:56	09/01/2020	EPA-200.8 (DW)	WP MTN
79468	LPS-1 Rm1BA1-F1-D1	Aqueous	09/01/2020 06:46	09/01/2020	EPA-200.8 (DW)	WP MTN
79469	LPS-1 Rm1BA1-F1-D2	Aqueous	09/01/2020 06:55	09/01/2020	EPA-200.8 (DW)	WP MTN
79470	LPS-1 Rm3-F1-D1	Aqueous	09/01/2020 06:44	09/01/2020	EPA-200.8 (DW)	WP MTN
79471	LPS-1 Rm3-F1-D2	Aqueous	09/01/2020 06:52	09/01/2020	EPA-200.8 (DW)	WP MTN
79472	LPS-1 Rm3-F2-D1	Aqueous	09/01/2020 06:43	09/01/2020	EPA-200.8 (DW)	WP MTN
79473	LPS-1 Rm3-F2-D1	Aqueous	09/01/2020 06:52	09/01/2020	EPA-200.8 (DW)	WP MTN
79474	LPS-1 Rm3BA1-F1-D1	Aqueous	09/01/2020 06:45	09/01/2020	EPA-200.8 (DW)	WP MTN

WP MTN - Memphis, TN: Waypoint Analytical - TN, Memphis, TN



**Sample Summary Table**

**Report Number:** 20-245-0008

**Client Project Description:** H2O in Lead at Lakeview Presbyterian Wee  
5915 Louis XIV Street, New Orleans, LA 7  
3921LDH-08

Lab No	Client Sample ID	Matrix	Date Collected	Date Received	Method	Lab ID
79475	LPS-1 Rm3BA1-F1-D2	Aqueous	09/01/2020 06:53	09/01/2020	EPA-200.8 (DW)	WP MTN

### Summary of Detected Analytes

**Project:** H2O in Lead at Lakeview Presbyterian Wee

**Report Number:** 20-245-0008

Client Sample ID Method	Lab Sample ID Parameters	Result	Units	Report Limit	Analyzed	Qualifiers
<b>LPS-1 Rm4-F1-D1</b>	<b>A 79450</b>					
EPA-200.8 (DW)	Lead	1.69	µg/L	0.500	09/08/2020 11:25	
<b>LPS-1 Rm4-F1-D2</b>	<b>A 79451</b>					
EPA-200.8 (DW)	Lead	1.97	µg/L	0.500	09/08/2020 11:26	
<b>LPS-1 Rm5-F1-D1</b>	<b>A 79452</b>					
EPA-200.8 (DW)	Lead	1.74	µg/L	0.500	09/08/2020 11:32	
<b>LPS-1 Rm5-F1-D2</b>	<b>A 79453</b>					
EPA-200.8 (DW)	Lead	1.77	µg/L	0.500	09/08/2020 11:33	
<b>LPS-1 Rm6-F1-D1</b>	<b>A 79454</b>					
EPA-200.8 (DW)	Lead	1.54	µg/L	0.500	09/08/2020 11:35	
<b>LPS-1 Rm6-F1-D2</b>	<b>A 79455</b>					
EPA-200.8 (DW)	Lead	2.29	µg/L	0.500	09/08/2020 11:36	
<b>LPS-1 Rm7-F1-D1</b>	<b>A 79456</b>					
EPA-200.8 (DW)	Lead	1.48	µg/L	0.500	09/08/2020 11:38	
<b>LPS-1 Rm7-F1-D2</b>	<b>A 79457</b>					
EPA-200.8 (DW)	Lead	1.60	µg/L	0.500	09/08/2020 11:39	
<b>LPS-1 1H1BA1-F1-D1</b>	<b>A 79458</b>					
EPA-200.8 (DW)	Lead	1.41	µg/L	0.500	09/08/2020 11:41	
<b>LPS-1 1H1BA1-F1-D2</b>	<b>A 79459</b>					
EPA-200.8 (DW)	Lead	1.22	µg/L	0.500	09/08/2020 11:42	
<b>LPS-1 1H1BA2-F1-D1</b>	<b>A 79460</b>					
EPA-200.8 (DW)	Lead	1.86	µg/L	0.500	09/08/2020 11:44	
<b>LPS-1 1H1BA2-F1-D2</b>	<b>A 79461</b>					
EPA-200.8 (DW)	Lead	1.56	µg/L	0.500	09/08/2020 11:46	
<b>LPS-1 Rm8-F1-D1</b>	<b>A 79462</b>					
EPA-200.8 (DW)	Lead	1.74	µg/L	0.500	09/08/2020 11:51	
<b>LPS-1 Rm8-F1-D2</b>	<b>A 79463</b>					
EPA-200.8 (DW)	Lead	1.96	µg/L	0.500	09/08/2020 11:53	



### Summary of Detected Analytes

**Project:** H2O in Lead at Lakeview Presbyterian Wee

**Report Number:** 20-245-0008

Client Sample ID Method	Lab Sample ID Parameters	Result	Units	Report Limit	Analyzed	Qualifiers
<b>LPS-1 Rm9-F1-D1</b>	<b>A 79464</b>					
EPA-200.8 (DW)	Lead	1.73	µg/L	0.500	09/08/2020 12:03	
<b>LPS-1 Rm9-F1-D2</b>	<b>A 79465</b>					
EPA-200.8 (DW)	Lead	1.70	µg/L	0.500	09/08/2020 12:05	
<b>LPS-1 Rm10-F1-D1</b>	<b>A 79466</b>					
EPA-200.8 (DW)	Lead	2.25	µg/L	0.500	09/08/2020 12:10	
<b>LPS-1 Rm10-F1-D2</b>	<b>A 79467</b>					
EPA-200.8 (DW)	Lead	1.95	µg/L	0.500	09/08/2020 12:12	
<b>LPS-1 Rm1BA1-F1-D1</b>	<b>A 79468</b>					
EPA-200.8 (DW)	Lead	1.51	µg/L	0.500	09/08/2020 12:13	
<b>LPS-1 Rm1BA1-F1-D2</b>	<b>A 79469</b>					
EPA-200.8 (DW)	Lead	1.58	µg/L	0.500	09/08/2020 12:15	
<b>LPS-1 Rm3-F1-D1</b>	<b>A 79470</b>					
EPA-200.8 (DW)	Lead	2.49	µg/L	0.500	09/08/2020 12:17	
<b>LPS-1 Rm3-F1-D2</b>	<b>A 79471</b>					
EPA-200.8 (DW)	Lead	1.48	µg/L	0.500	09/08/2020 12:18	
<b>LPS-1 Rm3-F2-D1</b>	<b>A 79472</b>					
EPA-200.8 (DW)	Lead	1.93	µg/L	0.500	09/08/2020 12:20	
<b>LPS-1 Rm3-F2-D1</b>	<b>A 79473</b>					
EPA-200.8 (DW)	Lead	1.36	µg/L	0.500	09/08/2020 12:21	
<b>LPS-1 Rm3BA1-F1-D1</b>	<b>A 79474</b>					
EPA-200.8 (DW)	Lead	1.27	µg/L	0.500	09/08/2020 12:23	
<b>LPS-1 Rm3BA1-F1-D2</b>	<b>A 79475</b>					
EPA-200.8 (DW)	Lead	14.0	µg/L	0.500	09/08/2020 12:24	

**Project** H2O in Lead at Lakeview Presbyterian \

**Information:** 5915 Louis XIV Street, New Orleans, LA  
 3921LDH-08

**Report Number:** 20-245-0008

**Report Date:** 9/9/2020

## Sample Results

### LPS-1 Rm4-F1-D1

**Date Collected** 09/01/2020 06:50 **WPA Lab No** 79450

**Date Received** 09/01/2020 **Matrix** Aqueous

### EPA-200.8 (DW)

Prep Date	Prep Batch	Prep Method	Sample	Dilution	Analysis Date	By	Analytical Batch
09/04/2020 11:45	L509900	EPA-200.8	50 mL	1	9/8/2020 11:25:10	BKN	L510425

CAS#	Parameter	Result	MQL	Units
7439-92-1	Lead	1.69	0.500	µg/L

### LPS-1 Rm4-F1-D2

**Date Collected** 09/01/2020 06:59 **WPA Lab No** 79451

**Date Received** 09/01/2020 **Matrix** Aqueous

### EPA-200.8 (DW)

Prep Date	Prep Batch	Prep Method	Sample	Dilution	Analysis Date	By	Analytical Batch
09/04/2020 11:45	L509900	EPA-200.8	50 mL	1	9/8/2020 11:26:42	BKN	L510425

CAS#	Parameter	Result	MQL	Units
7439-92-1	Lead	1.97	0.500	µg/L

### LPS-1 Rm5-F1-D1

**Date Collected** 09/01/2020 06:48 **WPA Lab No** 79452

**Date Received** 09/01/2020 **Matrix** Aqueous

### EPA-200.8 (DW)

Prep Date	Prep Batch	Prep Method	Sample	Dilution	Analysis Date	By	Analytical Batch
09/04/2020 11:45	L509900	EPA-200.8	50 mL	1	9/8/2020 11:32:20	BKN	L510425

CAS#	Parameter	Result	MQL	Units
7439-92-1	Lead	1.74	0.500	µg/L

**Qualifiers/** MQL Method Quantitation Limit  
**Definitions**

**Project** H2O in Lead at Lakeview Presbyterian \

**Information:** 5915 Louis XIV Street, New Orleans, LA  
3921LDH-08

**Report Number:** 20-245-0008  
**Report Date:** 9/9/2020

## Sample Results

### LPS-1 Rm5-F1-D2

**Date Collected** 09/01/2020 06:57 **WPA Lab No** 79453  
**Date Received** 09/01/2020 **Matrix** Aqueous

### EPA-200.8 (DW)

Prep Date	Prep Batch	Prep Method	Sample	Dilution	Analysis Date	By	Analytical Batch
09/04/2020 11:45	L509900	EPA-200.8	50 mL	1	9/8/2020 11:33:51	BKN	L510425

CAS#	Parameter	Result	MQL	Units
7439-92-1	Lead	1.77	0.500	µg/L

### LPS-1 Rm6-F1-D1

**Date Collected** 09/01/2020 06:47 **WPA Lab No** 79454  
**Date Received** 09/01/2020 **Matrix** Aqueous

### EPA-200.8 (DW)

Prep Date	Prep Batch	Prep Method	Sample	Dilution	Analysis Date	By	Analytical Batch
09/04/2020 11:45	L509900	EPA-200.8	50 mL	1	9/8/2020 11:35:21	BKN	L510425

CAS#	Parameter	Result	MQL	Units
7439-92-1	Lead	1.54	0.500	µg/L

### LPS-1 Rm6-F1-D2

**Date Collected** 09/01/2020 06:56 **WPA Lab No** 79455  
**Date Received** 09/01/2020 **Matrix** Aqueous

### EPA-200.8 (DW)

Prep Date	Prep Batch	Prep Method	Sample	Dilution	Analysis Date	By	Analytical Batch
09/04/2020 11:45	L509900	EPA-200.8	50 mL	1	9/8/2020 11:36:52	BKN	L510425

CAS#	Parameter	Result	MQL	Units
7439-92-1	Lead	2.29	0.500	µg/L

**Qualifiers/**  
**Definitions** MQL Method Quantitation Limit

**Project** H2O in Lead at Lakeview Presbyterian \

**Information:** 5915 Louis XIV Street, New Orleans, LA  
3921LDH-08

**Report Number:** 20-245-0008  
**Report Date:** 9/9/2020

## Sample Results

### LPS-1 Rm7-F1-D1

**Date Collected** 09/01/2020 06:46 **WPA Lab No** 79456  
**Date Received** 09/01/2020 **Matrix** Aqueous

### EPA-200.8 (DW)

Prep Date	Prep Batch	Prep Method	Sample	Dilution	Analysis Date	By	Analytical Batch
09/04/2020 11:45	L509900	EPA-200.8	50 mL	1	9/8/2020 11:38:23	BKN	L510425

CAS#	Parameter	Result	ML	Units
7439-92-1	Lead	1.48	0.500	µg/L

### LPS-1 Rm7-F1-D2

**Date Collected** 09/01/2020 06:55 **WPA Lab No** 79457  
**Date Received** 09/01/2020 **Matrix** Aqueous

### EPA-200.8 (DW)

Prep Date	Prep Batch	Prep Method	Sample	Dilution	Analysis Date	By	Analytical Batch
09/04/2020 11:45	L509900	EPA-200.8	50 mL	1	9/8/2020 11:39:54	BKN	L510425

CAS#	Parameter	Result	ML	Units
7439-92-1	Lead	1.60	0.500	µg/L

### LPS-1 1H1BA1-F1-D1

**Date Collected** 09/01/2020 06:49 **WPA Lab No** 79458  
**Date Received** 09/01/2020 **Matrix** Aqueous

### EPA-200.8 (DW)

Prep Date	Prep Batch	Prep Method	Sample	Dilution	Analysis Date	By	Analytical Batch
09/04/2020 11:45	L509900	EPA-200.8	50 mL	1	9/8/2020 11:41:25	BKN	L510425

CAS#	Parameter	Result	ML	Units
7439-92-1	Lead	1.41	0.500	µg/L

**Qualifiers/**  
**Definitions** MQL Method Quantitation Limit

**Project** H2O in Lead at Lakeview Presbyterian \

**Information:** 5915 Louis XIV Street, New Orleans, LA  
3921LDH-08

**Report Number:** 20-245-0008  
**Report Date:** 9/9/2020

## Sample Results

### LPS-1 1H1BA1-F1-D2

**Date Collected** 09/01/2020 07:00 **WPA Lab No** 79459  
**Date Received** 09/01/2020 **Matrix** Aqueous

### EPA-200.8 (DW)

Prep Date	Prep Batch	Prep Method	Sample	Dilution	Analysis Date	By	Analytical Batch
09/04/2020 11:45	L509900	EPA-200.8	50 mL	1	9/8/2020 11:42:57	BKN	L510425

CAS#	Parameter	Result	MQL	Units
7439-92-1	Lead	1.22	0.500	µg/L

### LPS-1 1H1BA2-F1-D1

**Date Collected** 09/01/2020 06:48 **WPA Lab No** 79460  
**Date Received** 09/01/2020 **Matrix** Aqueous

### EPA-200.8 (DW)

Prep Date	Prep Batch	Prep Method	Sample	Dilution	Analysis Date	By	Analytical Batch
09/04/2020 11:45	L509900	EPA-200.8	50 mL	1	9/8/2020 11:44:28	BKN	L510425

CAS#	Parameter	Result	MQL	Units
7439-92-1	Lead	1.86	0.500	µg/L

### LPS-1 1H1BA2-F1-D2

**Date Collected** 09/01/2020 06:59 **WPA Lab No** 79461  
**Date Received** 09/01/2020 **Matrix** Aqueous

### EPA-200.8 (DW)

Prep Date	Prep Batch	Prep Method	Sample	Dilution	Analysis Date	By	Analytical Batch
09/04/2020 11:45	L509900	EPA-200.8	50 mL	1	9/8/2020 11:46:00	BKN	L510425

CAS#	Parameter	Result	MQL	Units
7439-92-1	Lead	1.56	0.500	µg/L

**Qualifiers/**  
**Definitions** MQL Method Quantitation Limit

**Project** H2O in Lead at Lakeview Presbyterian \

**Information:** 5915 Louis XIV Street, New Orleans, LA  
3921LDH-08

**Report Number:** 20-245-0008  
**Report Date:** 9/9/2020

## Sample Results

### LPS-1 Rm8-F1-D1

**Date Collected** 09/01/2020 06:49 **WPA Lab No** 79462  
**Date Received** 09/01/2020 **Matrix** Aqueous

### EPA-200.8 (DW)

Prep Date	Prep Batch	Prep Method	Sample	Dilution	Analysis Date	By	Analytical Batch
09/04/2020 11:45	L509900	EPA-200.8	50 mL	1	9/8/2020 11:51:39	BKN	L510425

CAS#	Parameter	Result	MQL	Units
7439-92-1	Lead	1.74	0.500	µg/L

### LPS-1 Rm8-F1-D2

**Date Collected** 09/01/2020 06:58 **WPA Lab No** 79463  
**Date Received** 09/01/2020 **Matrix** Aqueous

### EPA-200.8 (DW)

Prep Date	Prep Batch	Prep Method	Sample	Dilution	Analysis Date	By	Analytical Batch
09/04/2020 11:45	L509900	EPA-200.8	50 mL	1	9/8/2020 11:53:10	BKN	L510425

CAS#	Parameter	Result	MQL	Units
7439-92-1	Lead	1.96	0.500	µg/L

### LPS-1 Rm9-F1-D1

**Date Collected** 09/01/2020 06:48 **WPA Lab No** 79464  
**Date Received** 09/01/2020 **Matrix** Aqueous

### EPA-200.8 (DW)

Prep Date	Prep Batch	Prep Method	Sample	Dilution	Analysis Date	By	Analytical Batch
09/04/2020 11:45	L509901	EPA-200.8	50 mL	1	9/8/2020 12:03:47	BKN	L510425

CAS#	Parameter	Result	MQL	Units
7439-92-1	Lead	1.73	0.500	µg/L

**Qualifiers/**  
**Definitions** MQL Method Quantitation Limit



**Project** H2O in Lead at Lakeview Presbyterian \

**Information:** 5915 Louis XIV Street, New Orleans, LA  
3921LDH-08

**Report Number:** 20-245-0008  
**Report Date:** 9/9/2020

## Sample Results

### LPS-1 Rm9-F1-D2

**Date Collected** 09/01/2020 06:57 **WPA Lab No** 79465  
**Date Received** 09/01/2020 **Matrix** Aqueous

### EPA-200.8 (DW)

Prep Date	Prep Batch	Prep Method	Sample	Dilution	Analysis Date	By	Analytical Batch
09/04/2020 11:45	L509901	EPA-200.8	50 mL	1	9/8/2020 12:05:19	BKN	L510425

CAS#	Parameter	Result	MQL	Units
7439-92-1	Lead	1.70	0.500	µg/L

### LPS-1 Rm10-F1-D1

**Date Collected** 09/01/2020 06:47 **WPA Lab No** 79466  
**Date Received** 09/01/2020 **Matrix** Aqueous

### EPA-200.8 (DW)

Prep Date	Prep Batch	Prep Method	Sample	Dilution	Analysis Date	By	Analytical Batch
09/04/2020 11:45	L509901	EPA-200.8	50 mL	1	9/8/2020 12:10:58	BKN	L510425

CAS#	Parameter	Result	MQL	Units
7439-92-1	Lead	2.25	0.500	µg/L

### LPS-1 Rm10-F1-D2

**Date Collected** 09/01/2020 06:56 **WPA Lab No** 79467  
**Date Received** 09/01/2020 **Matrix** Aqueous

### EPA-200.8 (DW)

Prep Date	Prep Batch	Prep Method	Sample	Dilution	Analysis Date	By	Analytical Batch
09/04/2020 11:45	L509901	EPA-200.8	50 mL	1	9/8/2020 12:12:28	BKN	L510425

CAS#	Parameter	Result	MQL	Units
7439-92-1	Lead	1.95	0.500	µg/L

**Qualifiers/**  
**Definitions** MQL Method Quantitation Limit

**Project** H2O in Lead at Lakeview Presbyterian \

**Information:** 5915 Louis XIV Street, New Orleans, LA  
3921LDH-08

**Report Number:** 20-245-0008  
**Report Date:** 9/9/2020

## Sample Results

### LPS-1 Rm1BA1-F1-D1

**Date Collected** 09/01/2020 06:46 **WPA Lab No** 79468  
**Date Received** 09/01/2020 **Matrix** Aqueous

### EPA-200.8 (DW)

Prep Date	Prep Batch	Prep Method	Sample	Dilution	Analysis Date	By	Analytical Batch
09/04/2020 11:45	L509901	EPA-200.8	50 mL	1	9/8/2020 12:13:59	BKN	L510425

CAS#	Parameter	Result	MQL	Units
7439-92-1	Lead	1.51	0.500	µg/L

### LPS-1 Rm1BA1-F1-D2

**Date Collected** 09/01/2020 06:55 **WPA Lab No** 79469  
**Date Received** 09/01/2020 **Matrix** Aqueous

### EPA-200.8 (DW)

Prep Date	Prep Batch	Prep Method	Sample	Dilution	Analysis Date	By	Analytical Batch
09/04/2020 11:45	L509901	EPA-200.8	50 mL	1	9/8/2020 12:15:30	BKN	L510425

CAS#	Parameter	Result	MQL	Units
7439-92-1	Lead	1.58	0.500	µg/L

### LPS-1 Rm3-F1-D1

**Date Collected** 09/01/2020 06:44 **WPA Lab No** 79470  
**Date Received** 09/01/2020 **Matrix** Aqueous

### EPA-200.8 (DW)

Prep Date	Prep Batch	Prep Method	Sample	Dilution	Analysis Date	By	Analytical Batch
09/04/2020 11:45	L509901	EPA-200.8	50 mL	1	9/8/2020 12:17:00	BKN	L510425

CAS#	Parameter	Result	MQL	Units
7439-92-1	Lead	2.49	0.500	µg/L

**Qualifiers/** MQL Method Quantitation Limit  
**Definitions**

**Project** H2O in Lead at Lakeview Presbyterian \

**Information:** 5915 Louis XIV Street, New Orleans, LA  
3921LDH-08

**Report Number:** 20-245-0008  
**Report Date:** 9/9/2020

## Sample Results

### LPS-1 Rm3-F1-D2

**Date Collected** 09/01/2020 06:52 **WPA Lab No** 79471  
**Date Received** 09/01/2020 **Matrix** Aqueous

### EPA-200.8 (DW)

Prep Date	Prep Batch	Prep Method	Sample	Dilution	Analysis Date	By	Analytical Batch
09/04/2020 11:45	L509901	EPA-200.8	50 mL	1	9/8/2020 12:18:31	BKN	L510425

CAS#	Parameter	Result	MQL	Units
7439-92-1	Lead	1.48	0.500	µg/L

### LPS-1 Rm3-F2-D1

**Date Collected** 09/01/2020 06:43 **WPA Lab No** 79472  
**Date Received** 09/01/2020 **Matrix** Aqueous

### EPA-200.8 (DW)

Prep Date	Prep Batch	Prep Method	Sample	Dilution	Analysis Date	By	Analytical Batch
09/04/2020 11:45	L509901	EPA-200.8	50 mL	1	9/8/2020 12:20:03	BKN	L510425

CAS#	Parameter	Result	MQL	Units
7439-92-1	Lead	1.93	0.500	µg/L

### LPS-1 Rm3-F2-D1

**Date Collected** 09/01/2020 06:52 **WPA Lab No** 79473  
**Date Received** 09/01/2020 **Matrix** Aqueous

### EPA-200.8 (DW)

Prep Date	Prep Batch	Prep Method	Sample	Dilution	Analysis Date	By	Analytical Batch
09/04/2020 11:45	L509901	EPA-200.8	50 mL	1	9/8/2020 12:21:34	BKN	L510425

CAS#	Parameter	Result	MQL	Units
7439-92-1	Lead	1.36	0.500	µg/L

**Qualifiers/**  
**Definitions** MQL Method Quantitation Limit

**Project** H2O in Lead at Lakeview Presbyterian \

**Information:** 5915 Louis XIV Street, New Orleans, LA  
3921LDH-08

**Report Number:** 20-245-0008

**Report Date:** 9/9/2020

## Sample Results

### LPS-1 Rm3BA1-F1-D1

**Date Collected** 09/01/2020 06:45 **WPA Lab No** 79474

**Date Received** 09/01/2020 **Matrix** Aqueous

### EPA-200.8 (DW)

Prep Date	Prep Batch	Prep Method	Sample	Dilution	Analysis Date	By	Analytical Batch
09/04/2020 11:45	L509901	EPA-200.8	50 mL	1	9/8/2020 12:23:06	BKN	L510425

CAS#	Parameter	Result	MQL	Units
7439-92-1	Lead	<b>1.27</b>	0.500	µg/L

### LPS-1 Rm3BA1-F1-D2

**Date Collected** 09/01/2020 06:53 **WPA Lab No** 79475

**Date Received** 09/01/2020 **Matrix** Aqueous

### EPA-200.8 (DW)

Prep Date	Prep Batch	Prep Method	Sample	Dilution	Analysis Date	By	Analytical Batch
09/04/2020 11:45	L509901	EPA-200.8	50 mL	1	9/8/2020 12:24:37	BKN	L510425

CAS#	Parameter	Result	MQL	Units
7439-92-1	Lead	<b>14.0</b>	0.500	µg/L

## Quality Control Data

**Client ID:** Materials Management Group, Inc.  
**Project Description:** H2O in Lead at Lakeview Presbyterian Weekday Schoo  
**Report No:** 20-245-0008

**QC Prep:** L509900 **QC Analytical Batch(es):** L510425  
**QC Prep Batch Method:** EPA-200.8 **Analysis Method:** EPA-200.8 (DW)  
**Analysis Description:** Metals Analyses

**Lab Reagent Blank** LRB-L509900 Matrix: AQU  
Associated Lab Samples: 79450, 79451, 79452, 79453, 79454, 79455, 79456, 79457, 79458, 79459, 79460, 79461, 79462, 79463

Parameter	Units	Blank Result	MQL	Analyzed
Lead	µg/L	< 0.500	0.500	09/08/20 11:13

**Laboratory Control Sample** LCS-L509900

Parameter	Units	Spike Conc.	LCS Result	LCS %Rec	% Rec Limits
Lead	µg/L	50.0	49.9	100	85-115

**Matrix Spike & Matrix Spike Duplicate** A 79463-MS-L509900 A 79463-MSD-L509900

Parameter	Units	Result	MS Spike Conc.	MSD Spike Conc.	MS Result	MSD Result	MS %Rec	MSD %Rec	%Rec Limits	RPD	Max RPD
Lead	µg/L	1.96	50.3	50.3	52.1	53.9	100	103	70-130	3.3	20.0

## Quality Control Data

**Client ID:** Materials Management Group, Inc.  
**Project Description:** H2O in Lead at Lakeview Presbyterian Weekday Schoo  
**Report No:** 20-245-0008

**QC Prep:** L509901 **QC Analytical Batch(es):** L510425  
**QC Prep Batch Method:** EPA-200.8 **Analysis Method:** EPA-200.8 (DW)  
**Analysis Description:** Metals Analyses

**Lab Reagent Blank** LRB-L509901 Matrix: AQU  
Associated Lab Samples: 79464, 79465, 79466, 79467, 79468, 79469, 79470, 79471, 79472, 79473, 79474, 79475

Parameter	Units	Blank Result	MQL	Analyzed
Lead	µg/L	< 0.500	0.500	09/08/20 12:00

**Laboratory Control Sample** LCS-L509901

Parameter	Units	Spike Conc.	LCS Result	LCS %Rec	% Rec Limits
Lead	µg/L	50.0	49.0	98.0	85-115

**Matrix Spike & Matrix Spike Duplicate** Q 92873-MS-L509901 Q 92873-MSD-L509901

Parameter	Units	Result	MS Spike Conc.	MSD Spike Conc.	MS Result	MSD Result	MS %Rec	MSD %Rec	%Rec Limits	RPD	Max RPD
Lead	µg/L	< 0.503	50.3	50.3	50.4	48.9	100	97.0	70-130	3.0	20.0



## Shipment Receipt Form

Customer Number: **01266**

Customer Name: **Materials Management Group, Inc.**

Report Number: **20-245-0008**

### Shipping Method



<input type="radio"/> Fed Ex	<input type="radio"/> US Postal	<input type="radio"/> Lab	<input type="radio"/> Other :	<input type="text"/>
<input type="radio"/> UPS	<input checked="" type="radio"/> Client	<input type="radio"/> Courier	Thermometer ID:	<input type="text"/>

Shipping container/cooler uncompromised?	<input checked="" type="radio"/> Yes	<input type="radio"/> No	
Number of coolers/boxes received	<input type="text" value="1"/>		
Custody seals intact on shipping container/cooler?	<input type="radio"/> Yes	<input type="radio"/> No	<input checked="" type="radio"/> Not Present
Custody seals intact on sample bottles?	<input type="radio"/> Yes	<input type="radio"/> No	<input checked="" type="radio"/> Not Present
Chain of Custody (COC) present?	<input checked="" type="radio"/> Yes	<input type="radio"/> No	
COC agrees with sample label(s)?	<input checked="" type="radio"/> Yes	<input type="radio"/> No	
COC properly completed	<input checked="" type="radio"/> Yes	<input type="radio"/> No	
Samples in proper containers?	<input checked="" type="radio"/> Yes	<input type="radio"/> No	
Sample containers intact?	<input checked="" type="radio"/> Yes	<input type="radio"/> No	
Sufficient sample volume for indicated test(s)?	<input checked="" type="radio"/> Yes	<input type="radio"/> No	
All samples received within holding time?	<input checked="" type="radio"/> Yes	<input type="radio"/> No	
Cooler temperature in compliance?	<input checked="" type="radio"/> Yes	<input type="radio"/> No	
Cooler/Samples arrived at the laboratory on ice. Samples were considered acceptable as cooling process had begun.	<input type="radio"/> Yes	<input checked="" type="radio"/> No	
Water - Sample containers properly preserved	<input checked="" type="radio"/> Yes	<input type="radio"/> No	<input type="radio"/> N/A
Water - VOA vials free of headspace	<input type="radio"/> Yes	<input type="radio"/> No	<input checked="" type="radio"/> N/A
Trip Blanks received with VOAs	<input type="radio"/> Yes	<input type="radio"/> No	<input checked="" type="radio"/> N/A
Soil VOA method 5035 – compliance criteria met	<input type="radio"/> Yes	<input type="radio"/> No	<input checked="" type="radio"/> N/A
<input type="checkbox"/> High concentration container (48 hr)	<input type="checkbox"/> Low concentration EnCore samplers (48 hr)		
<input type="checkbox"/> High concentration pre-weighed (methanol -14 d)	<input type="checkbox"/> Low conc pre-weighed vials (Sod Bis -14 d)		
Special precautions or instructions included?	<input type="radio"/> Yes	<input checked="" type="radio"/> No	

Comments:

Signature:

Date & Time:

<b>Client Name/Address</b> Materials Management Group, Inc. 2401 Westbend Parkway, #3010 New Orleans, LA 70114		<b>Client Project Manager/Contact</b> Erin LeCompte		<b>Billing Information</b> miab@mmgnola.com		 20-245-0008 01266 09-01-2020 12:32:11 Materials Management Group, Inc. H2O in Lead at Lakeview Presbyterian Weekday School							
<b>Project Description</b> H2O in Lead at Lakeview Presbyterian Weekday School		<b>Project/Site Location (City/State)</b> 5915 Louis XIV Street, New Orleans, LA 70124		<input type="checkbox"/> RUSH – Additional charges apply <input type="checkbox"/> Special Detection Limit(s) Date Results Needed		<b>Method of Shipment</b> <input type="checkbox"/> Fed Ex <input type="checkbox"/> UPS <input type="checkbox"/> USPS <input type="checkbox"/> Courier <input checked="" type="checkbox"/> Client Drop Off Other		<b>Matrix Key</b> WW – Wastewater    GW – Groundwater DW – Drinking Water    S – Soil /Solid    O – Oil P – Product    M – Misc					
<b>Project Number</b> 3921LDH-08		<b>Project Manager Phone #</b> 504-368-0568		<b>Project Manager Email</b> erinL@mmgnola.com		<b>Purchase Order Number</b> 3921LDH-08		<b>Site/Facility ID #</b>					
 5041 Taravella Road Marrero, LA 70072 (504) 371-8560		Unless noted, all containers per Table II of 40 CFR Part 136.		Number of Containers Matrix (Refer to Key) (G)rab or (C)omposite EPA 200.8		A Cool < 10C Na2S2O3 (Micro Only) B Cool <= 6C C H2SO4 pH<2 D None Required E NaOH pH>10 F HNO3 pH<2 G HCL pH<2 H H3PO4 pH<2 I Cool <= 6C NA2S2O3							
Date	Time	Sample Identification		Required Analysis / Preservative				Comments/Notes					
9/1/20	6:50	LPS-1Rm4-F1-D1		1	DW	G	1		79450				
9/1/20	6:59	LPS-1Rm4-F1-D2		1					79451				
9/1/20	6:48	LPS-1Rm5-F1-D1		1					79452				
9/1/20	6:57	LPS-1Rm5-F1-D2		1					79453				
9/1/20	6:47	LPS-1Rm6-F1-D1		1					79454				
9/1/20	6:56	LPS-1Rm6-F1-D2		1					79455				
9/1/20	6:46	LPS-1Rm7-F1-D1		1					79456				
9/1/20	6:55	LPS-1Rm7-F1-D2		1					79457				
9/1/20	6:49	LPS-1H1BA1-F1-D1		1					79458				
9/1/20	7:00	LPS-1H1BA1-F1-D2		1					79459				
For Laboratory Use Only				Sampled by (Name – Print)				Client Remarks/Comments					
Ice Y / N	Custody Seals Y / N	Lab Comments		Erin LeCompte				Page 1 of 3					
Blank/Cooler Temp N/A				Relinquished by: (SIGNATURE)				Date Time		Received by: (SIGNATURE)		Date Time	
				Relinquished by: (SIGNATURE)				Date Time		Received by: (SIGNATURE)		Date Time	
				Relinquished by: (SIGNATURE)				Date Time		Received by: (SIGNATURE)		Date Time	





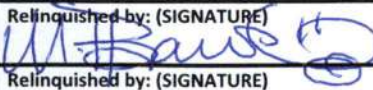
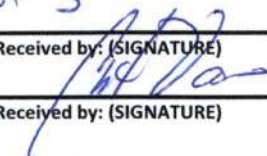

<b>Client Name/Address</b> Materials Management Group, Inc. 2401 Westbend Parkway, #3010 New Orleans, LA 70114		<b>Client Project Manager/Contact</b> Erin LeCompte		<b>Billing Information</b> miab@mmgnola.com		<b>For Laboratory Use Only</b>										
<b>Project Description</b> H2O in Lead at Lakeview Presbyterian Weekday School		<b>Project/Site Location (City/State)</b> 5915 Louis XIV Street, New Orleans, LA 70124		<input type="checkbox"/> RUSH – Additional charges apply <input type="checkbox"/> Special Detection Limit(s) Date Results Needed		<b>Method of Shipment</b> <input type="checkbox"/> Fed Ex <input type="checkbox"/> UPS <input type="checkbox"/> USPS <input type="checkbox"/> Courier <input type="checkbox"/> Client Drop Off Other				<b>Matrix Key</b> WW – Wastewater    GW – Groundwater DW – Drinking Water    S – Soil /Solid    O – Oil P - Product    M - Misc						
<b>Project Number</b> 3921LDH-08		<b>Project Manager Phone #</b> 504-368-0568		<b>Project Manager Email</b> erinL@mmgnola.com		<b>Purchase Order Number</b> 3921LDH-08				<b>Site/Facility ID #</b>						
 5041 Taravella Road Marrero, LA 70072 (504) 371-8560		Unless noted, all containers per Table II of 40 CFR Part 136.		Number of Containers	Matrix (Refer to Key)	(G)rab or (C)omposite	EPA 200.8								<b>Matrix Key</b> A Cool < 10C Na2S2O3 (Micro Only) B Cool <= 6C C H2SO4 pH<2 D None Required E NaOH pH>10 F HNO3 pH<2 G HCL pH<2 H H3PO4 pH<2 I Cool <= 6C NA2S2O3	
Date	Time	Sample Identification		Number of Containers	Matrix (Refer to Key)	(G)rab or (C)omposite	Required Analysis / Preservative				Comments/Notes					
9/1/20	6:44	LPS-1Rm3-F1-D1		1	DW	G	1								79470	
9/1/20	6:52	LPS-1Rm3-F1-D2		1	1	1									79471	
9/1/20	6:43	LPS-1Rm3-F2-D1		1	1	1									79472	
9/1/20	6:52	LPS-1Rm3-F2-D2		1	1	1									79473	
9/1/20	6:45	LPS-1Rm3BA1-F1-D1		1	1	1									79474	
9/1/20	6:53	LPS-1Rm3BA1-F1-D2		1	1	1									79475	

For Laboratory Use Only			<b>Sampled by (Name – Print)</b> Erin LeCompte		<b>Client Remarks/Comments</b> Page 3 of 3				
Ice Y/N	Custody Seals Y/N	Lab Comments	Relinquished by: (SIGNATURE) 		Date 9/1/20	Time 12:11 PM	Received by: (SIGNATURE) 	Date 9/1/20	Time 12:11
Blank/Cooler Temp			Relinquished by: (SIGNATURE)		Date	Time	Received by: (SIGNATURE)	Date	Time
			Relinquished by: (SIGNATURE)		Date	Time	Received by: (SIGNATURE)	Date	Time

**Water Sampling Report (Sampling Date: 9/1/2020)**

**Lakeview Presbyterian Weekday School  
5915 Louis XIV Street, New Orleans, LA 70124**

**Report Date: 9/14/2020  
MMG Job # 3921 LDH 08**

**Appendix C: Laboratory Accreditations and  
Certifications**



# State of Louisiana

Louisiana Department of Health  
Office of Public Health

June 30, 2020

Mr. Richard Medina  
Waypoint Analytical, LLC  
2790 Whitten Road  
Memphis, TN 38133

LA037

Dear Mr. Medina:

The requirements for maintaining your certification status for the State of Louisiana are outlined in the 2009 TNI standards and in the Louisiana Administrative Code (LAC) for the Accreditation of Laboratories Conducting Drinking Water Analyses located in LAC 48:V.Chapter 80, LAC 51:XII.101 and 301.

Your laboratory has chosen the State of Florida as its primary TNI accreditation body. Based on its accreditation, your laboratory is granted this **2020 Certificate of Laboratory Accreditation** for all the parameters listed. The certificate must be conspicuously displayed in the laboratory in a location visible to the public.

If there are any questions, please contact me at [Grant.Aucoin@LA.Gov](mailto:Grant.Aucoin@LA.Gov) or (225) 219-5202.

Sincerely,

A handwritten signature in blue ink, appearing to read "Grant Aucoin".

Grant Aucoin  
Laboratory Certification Program Manager

Enclosures





# STATE OF LOUISIANA

DEPARTMENT OF HEALTH  
OFFICE OF PUBLIC HEALTH



## Waypoint Analytical, LLC

2790 Whitten Road

Memphis, TN 38133

is accredited by the State of Louisiana in accordance with  
the 2009 TNI Standard and/or Department of Health regulations  
Louisiana Administrative Code 48:V.Chapter 80 and  
Louisiana Administrative Code 51:XII.101 and 301

Scope of accreditation is limited to the  
“TNI Accredited Fields of Testing”  
which accompany this certificate

Continued accredited status depends on successful  
ongoing participation in the program

CERTIFICATE NUMBER: LA037  
EFFECTIVE DATE: June 30, 2020  
EXPIRATION DATE: December 31, 2020

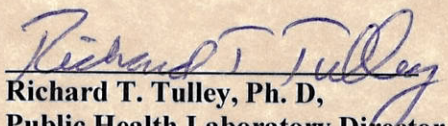
  
Richard T. Tulley, Ph. D.,  
Public Health Laboratory Director  
1209 Leesville Avenue  
Baton Rouge, Louisiana 70802

  
Grant Aucoin  
Laboratory Accreditation Program  
Manager

subject to forfeiture or revocation



**Louisiana Department of Health**

Office of Public Health  
1209 Leesville Avenue  
Baton Rouge, LA 70802  
(225) 219-5202



## Louisiana Accreditation - 2020

**Waypoint Analytical, LLC located in Memphis, TN**

meets all of the criteria necessary for ACCREDITATION by the State of Louisiana and The NELAC Institute (TNI) for the analysis of drinking water for the following contaminants:

### Drinking Water Parameters

Analyte	Method	Primary AB	Method Revision # or date	Technology Description	TNI Method Code	TNI Analyte Code
Lead	EPA 200.8	FL	rev 5.4	ICP-MS	10014605	1075

**The State of Florida is the primary TNI Accreditation Body for Waypoint Analytical, LLC. The Louisiana Department of Health is a secondary Accreditation Body for this laboratory. For a list of additional parameters, refer to the Florida Department of Health.**

Certificate #: LA037

Issue Date: 6/30/2020

Effective Date: 6/30/2020

Expires: 12/31/2020

Page 1 of 1