

**Sampling Date: June 26, 2020**  
**Submission Date: July 17, 2020**

# **Water Sampling Report**

## **Royal Castle Child Development Center**

**3800 Eagle Street, New Orleans, LA 70118**  
**(MMG Job # 3921 LDH 16)**



Prepared for:

Caryn Benjamin  
LDH-OPH, Engineering Services  
628 N. Fourth Street  
P.O. Box 4489  
Baton Rouge, LA 70821



By:

Materials Management Group, Inc.  
2401 Westbend Parkway, Suite 3010  
New Orleans, LA 70114

## Water Sampling Report (Sampling Date: 6/26/2020)

Royal Castle Child Development Center  
3800 Eagle Street, New Orleans, LA 70118

Report Date: 7/17/2020  
MMG # 3921 LDH 16

### Table of Contents

Table of Contents .....	1
1.0 Introduction.....	2
2.0 Summary of Activities .....	2
2.1 MMG Personnel .....	2
2.2 Methodology .....	2
2.3 Field Activities .....	3
3.0 Analytical Results.....	4
4.0 Recommendation(s) from LDH.....	5
5.0 Signature of Principal .....	5
Appendices .....	5
Appendix A: Sampling Maps	
Appendix B: Laboratory Report and Chain of Custody Documentation	
Appendix C: Laboratory Accreditations and Certifications	

## 1.0 Introduction

Materials Management Group, Inc. (MMG) was retained by the Louisiana Department of Health – Office of Public Health (LDH-OPH) to conduct water sampling for the potential presence and concentration of lead in drinking water at primary schools and childcare facilities throughout Louisiana. MMG's scope of work includes testing sources of water used for consumption in a given school or childcare facility as determined by representatives of LDH-OPH. This report summarizes water testing performed at Royal Castle Child Development Center, 3800 Eagle Street, New Orleans, LA 70118 (School).

MMG personnel Braelin Carter and Erin LeCompte performed the initial facility assessment on April 29, 2020. A water sampling plan was submitted to LDH-OPH on May 22, 2020 and approved on May 26, 2020. Water sampling was performed at the School on June 26, 2020 by MMG staff.

## 2.0 Summary of Activities

### 2.1 MMG Personnel

Multiple MMG personnel participated in this water sampling assessment and investigation. All MMG personnel that conduct water sampling are LDEQ-accredited Lead Inspectors and Lead Risk Assessors. Table 2.1 below summarizes MMG personnel who conducted water sampling at the School and includes their certification information.

**Table 2.1 MMG Personnel Accreditation Information Summary**

<b>MMG Personnel</b>	<b>Accreditation Type</b>	<b>Certification Number</b>	<b>Date of Expiration</b>
<b>Braelin Carter</b>	Lead Inspector	OI193973	10/15/2020
	Lead Risk Assessor	OR193973	10/16/2020
<b>Jeff Camus</b>	Lead Inspector	MI182306	03/05/2021
	Lead Risk Assessor	MR182306	03/06/2021
<b>Erin LeCompte</b>	Lead Inspector	OI217986	10/07/2020
	Lead Risk Assessor	OR217986	10/07/2020
<b>Dr. C. Paul Lo</b>	Lead Inspector	JI121486	1/8/2021
	Lead Risk Assessor	JR121486	1/9/2021
	Lead Project Supervisor	JS121486	1/10/2021
	Lead Designer	JD121486	1/10/2021
<b>Justin Crochet</b>	Lead Inspector	MI184257	3/5/2021
	Lead Risk Assessor	MR184257	3/6/2021

### 2.2 Methodology

The MMG team utilized the water sampling methodology described in the guidance document, "3 T's for Reducing Lead in Drinking Water in Schools and Child Care Facilities: A Training, Testing, and Taking Action Approach", authored

## Water Sampling Report (Sampling Date: 6/26/2020)

Royal Castle Child Development Center  
3800 Eagle Street, New Orleans, LA 70118

Report Date: 7/17/2020  
MMG # 3921 LDH 16

by the Environmental Protection Agency (EPA), Office of Ground Water and Drinking Water.

The EPA recommends schools and childcare facilities use a 2-step sampling procedure which specifies the collection of two (2) water samples per fixture. The “1<sup>st</sup> Draw” sample is taken from the fixture once water has been sitting stagnant in the fixture for no less than 8 hours and no more than 18 hours. The “2<sup>nd</sup> Draw” sample is then collected from the same fixture after the fixture has been “flushed” for a pre-determined length of time. “Flushing” a fixture is accomplished by running water through the fixture at a moderate flow rate for 30 seconds (in the case of faucets and bubblers) or 15 minutes (in the case of water coolers or other fixtures which include a holding tank or similar water storage/refrigeration component). Using the “2-draw” method of water sampling described in the “3 T’s” document is meant to ensure that the water samples collected at a given facility are representative of water quality and usage under “normal” conditions.

All water samples were collected in individual 250 mL plastic bottles, with preservatives, provided by the testing laboratory.

### 2.3 *Field Activities*

MMG performed all water sampling activities at the School on June 26, 2020 beginning at approximately 6:00 AM. Samples were collected from fixtures pre-approved by LDH with the following exceptions:

- Sample #'s **RCK1-1Rm2WC1-D1 and -D2** were not collected.
  - This fixture was a water cooler previously located in Room 2.
  - This fixture had been uninstalled (physically removed from the wall) at the time water sampling work was performed and was not available for sampling.
- Sample #'s **RCK1-1Rm10F1-D1 and -D2** were not collected.
  - This fixture is a handwash sink located in Room 10.
  - Room 10 was undergoing renovation at the time water sampling work was performed.
  - Access to Room 10 had been restricted to renovation personnel only and the door to Room 10 had been physically blocked.
- Sample #'s **RCK1-1Rm11F1-D1 and -D2** were not collected.
  - This fixture is a handwash sink located in Room 11.
  - Room 11 was undergoing renovation at the time water sampling work was performed.
  - Access to Room 11 had been restricted to renovation personnel only and the door to Room 11 had been physically blocked.

See Appendix A: Sampling Maps for illustrated locations of each sample.

## Water Sampling Report (Sampling Date: 6/26/2020)

Royal Castle Child Development Center  
3800 Eagle Street, New Orleans, LA 70118

Report Date: 7/17/2020  
MMG # 3921 LDH 16

After collection, water samples were transported via courier to the SGS Laboratory in Scott, Louisiana for analysis. All samples were analyzed for lead concentration using the EPA 200.8 Method with ICP-MS. Laboratory certifications issued for SGS Laboratory by the Louisiana Department of Environmental Quality (LDEQ) and the Louisiana Department of Health and Hospital (LDOH) are included in Appendix C.

### 3.0 Analytical Results

Table 3.1 summarizes the analytical results for the water samples taken by MMG from Royal Castle Child Development Center on June 26, 2020. The complete analytical reports for all water samples taken over the course of the investigation, including chain-of-custody documentation, can be found in Appendix B.

**Table 3.1 Water Sampling Results for Royal Castle Child Development Center**

Sample #	Sample Locations	Description	Result (mg/L)
RCK1-1RM2-F1-D1	Building 1, 1 <sup>st</sup> Floor, Room 2, Faucet 1	First Draw	0.00089
RCK1-1RM2-F1-D2	Building 1, 1 <sup>st</sup> Floor, Room 2, Faucet 1	Second Draw	0.0032
RCK1-1RM2BA1-F1-D1	Building 1, 1 <sup>st</sup> Floor, Room 2, Bathroom 1, Faucet 1	First Draw	0.0015
RCK1-1RM2BA1-F1-D2	Building 1, 1 <sup>st</sup> Floor, Room 2, Bathroom 1, Faucet 1	Second Draw	0.0029
RCK1-1RM3-WC1-D1	Building 1, 1 <sup>st</sup> Floor, Room 3, Water Cooler 1	First Draw	0.0019
RCK1-1RM3-WC1-D2	Building 1, 1 <sup>st</sup> Floor, Room 3, Water Cooler 1	Second Draw	0.0015
RCK1-1RM3-F1-D1	Building 1, 1 <sup>st</sup> Floor, Room 3, Faucet 1	First Draw	0.013
RCK1-1RM3-F1-D2	Building 1, 1 <sup>st</sup> Floor, Room 3, Faucet 1	Second Draw	0.0027
RCK1-1RM5-F1-D1	Building 1, 1 <sup>st</sup> Floor, Room 5, Faucet 1	First Draw	0.0015
RCK1-1RM5-F1-D2	Building 1, 1 <sup>st</sup> Floor, Room 5, Faucet 1	Second Draw	0.0015
RCK1-1RM5BA1-F1-D1	Building 1, 1 <sup>st</sup> Floor, Room 5, Bathroom 1, Faucet 1	First Draw	0.0051
RCK1-1RM5BA1-F1-D2	Building 1, 1 <sup>st</sup> Floor, Room 5, Bathroom 1, Faucet 1	Second Draw	0.0018
RCK1-1RM6-F1-D1	Building 1, 1 <sup>st</sup> Floor, Room 6, Faucet 1	First Draw	0.0046
RCK1-1RM6-F1-D2	Building 1, 1 <sup>st</sup> Floor, Room 6, Faucet 1	Second Draw	0.0015
RCK1-1RM6BA1-F1-D1	Building 1, 1 <sup>st</sup> Floor, Room 6, Bathroom 1, Faucet 1	First Draw	0.077
RCK1-1RM6BA1-F1-D2	Building 1, 1 <sup>st</sup> Floor, Room 6, Bathroom 1, Faucet 1	Second Draw	0.0038
RCK1-1RM7-F1-D1	Building 1, 1 <sup>st</sup> Floor, Room 7, Faucet 1	First Draw	0.0036
RCK1-1RM7-F1-D2	Building 1, 1 <sup>st</sup> Floor, Room 7, Faucet 1	Second Draw	0.00074
RCK1-1RM8-F1-D1	Building 1, 1 <sup>st</sup> Floor, Room 8, Faucet 1	First Draw	0.021
RCK1-1RM8-F1-D2	Building 1, 1 <sup>st</sup> Floor, Room 8, Faucet 1	Second Draw	0.0035
RCK1-1RM9-F1-D1	Building 1, 1 <sup>st</sup> Floor, Room 9, Faucet 1	First Draw	0.0011
RCK1-1RM9-F1-D2	Building 1, 1 <sup>st</sup> Floor, Room 9, Faucet 1	Second Draw	0.00070
RCK1-1H3BA1-F1-D1	Building 1, 1 <sup>st</sup> Floor, Hallway 3, Bathroom 1,	First Draw	0.0023

## Water Sampling Report (Sampling Date: 6/26/2020)

Royal Castle Child Development Center  
3800 Eagle Street, New Orleans, LA 70118

Report Date: 7/17/2020  
MMG # 3921 LDH 16

Sample #	Sample Locations	Description	Result (mg/L)
	Faucet 1		
RCK1-1H3BA1-F1-D2	Building 1, 1 <sup>st</sup> Floor, Hallway 3, Bathroom 1, Faucet 1	Second Draw	0.0057
RCK1-1H3BA2-F1-D1	Building 1, 1 <sup>st</sup> Floor, Hallway 2, Bathroom 2, Faucet 1	First Draw	0.0088
RCK1-1H3BA2-F1-D2	Building 1, 1 <sup>st</sup> Floor, Hallway 2, Bathroom 2, Faucet 1	Second Draw	0.0021
RCK1-1H1BA1-F1-D1	Building 1, 1 <sup>st</sup> Floor, Hallway 1, Bathroom 1, Faucet 1	First Draw	0.0012
RCK1-1H1BA1-F1-D2	Building 1, 1 <sup>st</sup> Floor, Hallway 1, Bathroom 1, Faucet 1	Second Draw	0.0038
RCK1-1RM12KT-F1-D1	Building 1, 1 <sup>st</sup> Floor, Room 12, Kitchen, Faucet 1	First Draw	0.0016
RCK1-1RM12KT-F1-D2	Building 1, 1 <sup>st</sup> Floor, Room 12, Kitchen, Faucet 1	Second Draw	0.0028
RCK1-1RM12KT-F2-D1	Building 1, 1 <sup>st</sup> Floor, Room 12, Kitchen, Faucet 2	First Draw	0.0011
RCK1-1RM12KT-F2-D2	Building 1, 1 <sup>st</sup> Floor, Room 12, Kitchen, Faucet 2	Second Draw	0.0024

### 4.0 Recommendation(s) from LDH-OPH

At the request of LDH-OPH, MMG has included the following recommendation(s) in this report:

*The Louisiana Department of Health recommends that Facilities should not use water from hose bibbs for potable purposes such as consumption, food/drink preparation, and cooking.*

### 5.0 Signature of Principal



C. Paul Lo, ScD

Principal Environmental Health Scientist & LDEQ Lead Project Designer

## Appendices

Appendix A: Sampling Maps

Appendix B: Laboratory Report and Chain of Custody Documentation

Appendix C: Laboratory Accreditations and Certifications

**Water Sampling Report (Sampling Date: 6/26/2020)**

**Royal Castle Child Development Center  
3800 Eagle Street, New Orleans, LA 70118**

**Report Date: 7/17/2020  
MMG # 3921 LDH 16**

---

**Appendix A: Sampling Maps**

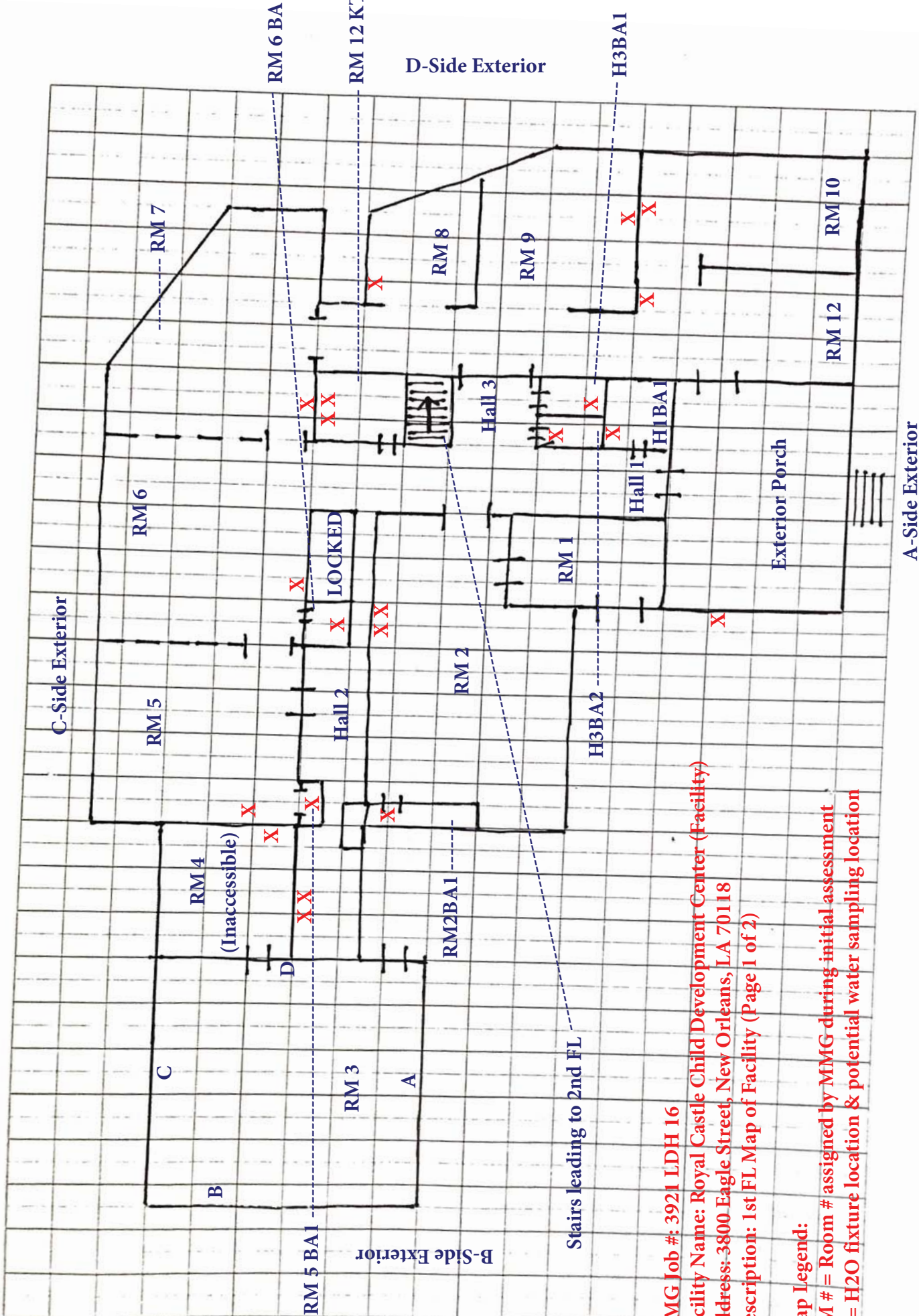

MMG Job #: 3921 LDH 16  
 Facility Name: Royal Castle Child Development Center (Facility)  
 Address: 3800 Eagle Street, New Orleans, LA 70118  
 Description: 1st FL Map of Facility (Page 1 of 2)

Map Legend:  
 RM # = Room # assigned by MMG during initial assessment  
 X = H2O fixture location & potential water sampling location

**Water Sampling Report (Sampling Date: 6/26/2020)**

**Royal Castle Child Development Center  
3800 Eagle Street, New Orleans, LA 70118**

**Report Date: 7/17/2020  
MMG # 3921 LDH 16**

**Appendix B: Laboratory Report and Chain of Custody  
Documentation**

The results set forth herein are provided by SGS North America Inc.

*e-Hardcopy 2.0*  
*Automated Report*

## Technical Report for

### Materials Management Group

Drinking H2O Sampling at RCK, 3800 Eagle Street, New Orleans, LA

3921LDH16

SGS Job Number: LA64900

Sampling Date: 06/26/20

### Report to:

Materials Management Group  
3520 General Degaulle Drive Suite 3010  
New Orleans, LA 70114  
braelinc@mmgnola.com

ATTN: Braelin Carter

Total number of pages in report: 72



Test results contained within this data package meet the requirements of the National Environmental Laboratory Accreditation Program and/or state specific certification programs as applicable.

*Ron Benjamin*  
**Ron Benjamin**  
Lab Director

**Client Service contact: Amy Jackson 337-237-4775**

Certifications: LDEQ(2048), LDHH(LA150012), AR(14-045-04), AZ(AZ0805), FL(E87657), IL(200082), KY(#31), NC(487), SC(73004001), NJ(LA007), TX(T104704186-18-16), WV(257)

This report shall not be reproduced, except in its entirety, without the written approval of SGS.  
Test results relate only to samples analyzed.

# Table of Contents

-1-

<b>Section 1: Sample Summary .....</b>	<b>4</b>
<b>Section 2: Summary of Hits .....</b>	<b>7</b>
<b>Section 3: Sample Results .....</b>	<b>10</b>
<b>3.1:</b> LA64900-1: RCK1-1RM2-F1-D1 .....	11
<b>3.2:</b> LA64900-2: RCK1-1RM2-F1-D2 .....	12
<b>3.3:</b> LA64900-3: RCK1-1RM2BA1-F1-D1 .....	13
<b>3.4:</b> LA64900-4: RCK1-1RM2BA1-F1-D2 .....	14
<b>3.5:</b> LA64900-5: RCK1-1RM3-WC1-D1 .....	15
<b>3.6:</b> LA64900-6: RCK1-1RM3-WC1-D2 .....	16
<b>3.7:</b> LA64900-7: RCK1-1RM3-F1-D1 .....	17
<b>3.8:</b> LA64900-8: RCK1-1RM3-F1-D2 .....	18
<b>3.9:</b> LA64900-9: RCK1-1RM5-F1-D1 .....	19
<b>3.10:</b> LA64900-10: RCK1-1RM5-F1-D2 .....	20
<b>3.11:</b> LA64900-11: RCK1-1RM5BA1-F1-D1 .....	21
<b>3.12:</b> LA64900-12: RCK1-1RM5BA1-F1-D2 .....	22
<b>3.13:</b> LA64900-13: RCK1-1RM6-F1-D1 .....	23
<b>3.14:</b> LA64900-14: RCK1-1RM6-F1-D2 .....	24
<b>3.15:</b> LA64900-15: RCK1-1RM6BA1-F1-D1 .....	25
<b>3.16:</b> LA64900-16: RCK1-1RM6BA1-F1-D2 .....	26
<b>3.17:</b> LA64900-17: RCK1-1RM7-F1-D1 .....	27
<b>3.18:</b> LA64900-18: RCK1-1RM7-F1-D2 .....	28
<b>3.19:</b> LA64900-19: RCK1-1RM8-F1-D1 .....	29
<b>3.20:</b> LA64900-20: RCK1-1RM8-F1-D2 .....	30
<b>3.21:</b> LA64900-21: RCK1-1RM9-F1-D1 .....	31
<b>3.22:</b> LA64900-22: RCK1-1RM9-F1-D2 .....	32
<b>3.23:</b> LA64900-23: RCK1-1H3BA1-F1-D1 .....	33
<b>3.24:</b> LA64900-24: RCK1-1H3BA1-F1-D2 .....	34
<b>3.25:</b> LA64900-25: RCK1-1H2BA2-F1-D1 .....	35
<b>3.26:</b> LA64900-26: RCK1-1H2BA2-F1-D2 .....	36
<b>3.27:</b> LA64900-27: RCK1-1H1BA1-F1-D1 .....	37
<b>3.28:</b> LA64900-28: RCK1-1H1BA1-F1-D2 .....	38
<b>3.29:</b> LA64900-29: RCK1-1RM12KT-F1-D1 .....	39
<b>3.30:</b> LA64900-30: RCK1-1RM12KT-F1-D2 .....	40
<b>3.31:</b> LA64900-31: RCK1-1RM12KT-F2-D1 .....	41
<b>3.32:</b> LA64900-32: RCK1-1RM12KT-F2-D2 .....	42
<b>Section 4: Misc. Forms .....</b>	<b>43</b>
<b>4.1:</b> Chain of Custody .....	44
<b>Section 5: Misc. Forms (SGS Wheat Ridge, CO) .....</b>	<b>52</b>
<b>5.1:</b> Chain of Custody .....	53
<b>Section 6: Metals Analysis - QC Data (SGS Wheat Ridge, CO) .....</b>	<b>56</b>
<b>6.1:</b> Prep QC MP30652: Pb .....	57
<b>6.2:</b> Prep QC MP30663: Pb .....	61

# Table of Contents

Sections:

1

2

3

4

5

6

-2-

6.3: Prep QC MP30664: Pb .....	65
6.4: Prep QC MP30665: Pb .....	69



Sample Summary

Materials Management Group

Job No: LA64900

Drinking H2O Sampling at RCK, 3800 Eagle Street, New Orleans, LA  
Project No: 3921LDH16

Sample Number	Collected Date	Time By	Received	Matrix Code	Type	Client Sample ID
LA64900-1	06/26/20	06:06 EL	06/26/20	DW	Drinking Water	RCK1-1RM2-F1-D1
LA64900-2	06/26/20	06:22 EL	06/26/20	DW	Drinking Water	RCK1-1RM2-F1-D2
LA64900-3	06/26/20	06:08 EL	06/26/20	DW	Drinking Water	RCK1-1RM2BA1-F1-D1
LA64900-4	06/26/20	06:24 EL	06/26/20	DW	Drinking Water	RCK1-1RM2BA1-F1-D2
LA64900-5	06/26/20	06:09 EL	06/26/20	DW	Drinking Water	RCK1-1RM3-WC1-D1
LA64900-6	06/26/20	06:45 EL	06/26/20	DW	Drinking Water	RCK1-1RM3-WC1-D2
LA64900-7	06/26/20	06:11 EL	06/26/20	DW	Drinking Water	RCK1-1RM3-F1-D1
LA64900-8	06/26/20	06:26 EL	06/26/20	DW	Drinking Water	RCK1-1RM3-F1-D2
LA64900-9	06/26/20	06:13 EL	06/26/20	DW	Drinking Water	RCK1-1RM5-F1-D1
LA64900-10	06/26/20	06:27 EL	06/26/20	DW	Drinking Water	RCK1-1RM5-F1-D2
LA64900-11	06/26/20	06:14 EL	06/26/20	DW	Drinking Water	RCK1-1RM5BA1-F1-D1
LA64900-12	06/26/20	06:28 EL	06/26/20	DW	Drinking Water	RCK1-1RM5BA1-F1-D2
LA64900-13	06/26/20	06:16 EL	06/26/20	DW	Drinking Water	RCK1-1RM6-F1-D1



Sample Summary  
(continued)

Materials Management Group

Job No: LA64900

Drinking H2O Sampling at RCK, 3800 Eagle Street, New Orleans, LA  
Project No: 3921LDH16

Sample Number	Collected Date	Time By	Received	Matrix Code	Type	Client Sample ID
LA64900-14	06/26/20	06:30 EL	06/26/20	DW	Drinking Water	RCK1-1RM6-F1-D2
LA64900-15	06/26/20	06:17 EL	06/26/20	DW	Drinking Water	RCK1-1RM6BA1-F1-D1
LA64900-16	06/26/20	06:31 EL	06/26/20	DW	Drinking Water	RCK1-1RM6BA1-F1-D2
LA64900-17	06/26/20	06:18 EL	06/26/20	DW	Drinking Water	RCK1-1RM7-F1-D1
LA64900-18	06/26/20	06:32 EL	06/26/20	DW	Drinking Water	RCK1-1RM7-F1-D2
LA64900-19	06/26/20	06:14 EL	06/26/20	DW	Drinking Water	RCK1-1RM8-F1-D1
LA64900-20	06/26/20	06:17 EL	06/26/20	DW	Drinking Water	RCK1-1RM8-F1-D2
LA64900-21	06/26/20	06:13 EL	06/26/20	DW	Drinking Water	RCK1-1RM9-F1-D1
LA64900-22	06/26/20	06:15 EL	06/26/20	DW	Drinking Water	RCK1-1RM9-F1-D2
LA64900-23	06/26/20	06:07 EL	06/26/20	DW	Drinking Water	RCK1-1H3BA1-F1-D1
LA64900-24	06/26/20	06:32 EL	06/26/20	DW	Drinking Water	RCK1-1H3BA1-F1-D2
LA64900-25	06/26/20	06:05 EL	06/26/20	DW	Drinking Water	RCK1-1H2BA2-F1-D1
LA64900-26	06/26/20	06:30 EL	06/26/20	DW	Drinking Water	RCK1-1H2BA2-F1-D2



Sample Summary  
(continued)

Materials Management Group

Job No: LA64900

Drinking H2O Sampling at RCK, 3800 Eagle Street, New Orleans, LA  
Project No: 3921LDH16

Sample Number	Collected Date	Time By	Received	Matrix Code	Type	Client Sample ID
LA64900-27	06/26/20	06:10 EL	06/26/20	DW	Drinking Water	RCK1-1H1BA1-F1-D1
LA64900-28	06/26/20	06:34 EL	06/26/20	DW	Drinking Water	RCK1-1H1BA1-F1-D2
LA64900-29	06/26/20	06:06 EL	06/26/20	DW	Drinking Water	RCK1-1RM12KT-F1-D1
LA64900-30	06/26/20	06:30 EL	06/26/20	DW	Drinking Water	RCK1-1RM12KT-F1-D2
LA64900-31	06/26/20	06:07 EL	06/26/20	DW	Drinking Water	RCK1-1RM12KT-F2-D1
LA64900-32	06/26/20	06:33 EL	06/26/20	DW	Drinking Water	RCK1-1RM12KT-F2-D2

## Summary of Hits

Page 1 of 3

**Job Number:** LA64900  
**Account:** Materials Management Group  
**Project:** Drinking H2O Sampling at RCK, 3800 Eagle Street, New Orleans, LA  
**Collected:** 06/26/20

Lab Sample ID Analyte	Client Sample ID	Result/ Qual	RL	MDL	Units	Method
<b>LA64900-1</b>	<b>RCK1-1RM2-F1-D1</b>					
Lead <sup>a</sup>		0.00089	0.00050		mg/l	EPA 200.8
<b>LA64900-2</b>	<b>RCK1-1RM2-F1-D2</b>					
Lead <sup>a</sup>		0.0032	0.00050		mg/l	EPA 200.8
<b>LA64900-3</b>	<b>RCK1-1RM2BA1-F1-D1</b>					
Lead <sup>a</sup>		0.0015	0.00050		mg/l	EPA 200.8
<b>LA64900-4</b>	<b>RCK1-1RM2BA1-F1-D2</b>					
Lead <sup>a</sup>		0.0029	0.00050		mg/l	EPA 200.8
<b>LA64900-5</b>	<b>RCK1-1RM3-WC1-D1</b>					
Lead <sup>a</sup>		0.0019	0.00050		mg/l	EPA 200.8
<b>LA64900-6</b>	<b>RCK1-1RM3-WC1-D2</b>					
Lead <sup>a</sup>		0.0015	0.00050		mg/l	EPA 200.8
<b>LA64900-7</b>	<b>RCK1-1RM3-F1-D1</b>					
Lead <sup>a</sup>		0.013	0.00050		mg/l	EPA 200.8
<b>LA64900-8</b>	<b>RCK1-1RM3-F1-D2</b>					
Lead <sup>a</sup>		0.0027	0.00050		mg/l	EPA 200.8
<b>LA64900-9</b>	<b>RCK1-1RM5-F1-D1</b>					
Lead <sup>a</sup>		0.0015	0.00050		mg/l	EPA 200.8
<b>LA64900-10</b>	<b>RCK1-1RM5-F1-D2</b>					
Lead <sup>a</sup>		0.0015	0.00050		mg/l	EPA 200.8
<b>LA64900-11</b>	<b>RCK1-1RM5BA1-F1-D1</b>					
Lead <sup>a</sup>		0.0051	0.00050		mg/l	EPA 200.8

## Summary of Hits

**Job Number:** LA64900  
**Account:** Materials Management Group  
**Project:** Drinking H2O Sampling at RCK, 3800 Eagle Street, New Orleans, LA  
**Collected:** 06/26/20

Lab Sample ID Analyte	Client Sample ID	Result/ Qual	RL	MDL	Units	Method
<b>LA64900-12</b>	<b>RCK1-1RM5BA1-F1-D2</b>					
Lead <sup>a</sup>		0.0018	0.00050		mg/l	EPA 200.8
<b>LA64900-13</b>	<b>RCK1-1RM6-F1-D1</b>					
Lead <sup>a</sup>		0.0046	0.00050		mg/l	EPA 200.8
<b>LA64900-14</b>	<b>RCK1-1RM6-F1-D2</b>					
Lead <sup>a</sup>		0.0015	0.00050		mg/l	EPA 200.8
<b>LA64900-15</b>	<b>RCK1-1RM6BA1-F1-D1</b>					
Lead <sup>a</sup>		0.077	0.00050		mg/l	EPA 200.8
<b>LA64900-16</b>	<b>RCK1-1RM6BA1-F1-D2</b>					
Lead <sup>a</sup>		0.0038	0.00050		mg/l	EPA 200.8
<b>LA64900-17</b>	<b>RCK1-1RM7-F1-D1</b>					
Lead <sup>a</sup>		0.0036	0.00050		mg/l	EPA 200.8
<b>LA64900-18</b>	<b>RCK1-1RM7-F1-D2</b>					
Lead <sup>a</sup>		0.00074	0.00050		mg/l	EPA 200.8
<b>LA64900-19</b>	<b>RCK1-1RM8-F1-D1</b>					
Lead <sup>a</sup>		0.021	0.00050		mg/l	EPA 200.8
<b>LA64900-20</b>	<b>RCK1-1RM8-F1-D2</b>					
Lead <sup>a</sup>		0.0035	0.00050		mg/l	EPA 200.8
<b>LA64900-21</b>	<b>RCK1-1RM9-F1-D1</b>					
Lead <sup>a</sup>		0.0011	0.00050		mg/l	EPA 200.8
<b>LA64900-22</b>	<b>RCK1-1RM9-F1-D2</b>					
Lead <sup>a</sup>		0.00070	0.00050		mg/l	EPA 200.8

## Summary of Hits

**Job Number:** LA64900  
**Account:** Materials Management Group  
**Project:** Drinking H2O Sampling at RCK, 3800 Eagle Street, New Orleans, LA  
**Collected:** 06/26/20

Lab Sample ID Analyte	Client Sample ID	Result/ Qual	RL	MDL	Units	Method
LA64900-23	RCK1-1H3BA1-F1-D1					
Lead <sup>a</sup>		0.0023	0.00050		mg/l	EPA 200.8
LA64900-24	RCK1-1H3BA1-F1-D2					
Lead <sup>a</sup>		0.0057	0.00050		mg/l	EPA 200.8
LA64900-25	RCK1-1H2BA2-F1-D1					
Lead <sup>a</sup>		0.0088	0.00050		mg/l	EPA 200.8
LA64900-26	RCK1-1H2BA2-F1-D2					
Lead <sup>a</sup>		0.0021	0.00050		mg/l	EPA 200.8
LA64900-27	RCK1-1H1BA1-F1-D1					
Lead <sup>a</sup>		0.0012	0.00050		mg/l	EPA 200.8
LA64900-28	RCK1-1H1BA1-F1-D2					
Lead <sup>a</sup>		0.0038	0.00050		mg/l	EPA 200.8
LA64900-29	RCK1-1RM12KT-F1-D1					
Lead <sup>a</sup>		0.0016	0.00050		mg/l	EPA 200.8
LA64900-30	RCK1-1RM12KT-F1-D2					
Lead <sup>a</sup>		0.0028	0.00050		mg/l	EPA 200.8
LA64900-31	RCK1-1RM12KT-F2-D1					
Lead <sup>a</sup>		0.0011	0.00050		mg/l	EPA 200.8
LA64900-32	RCK1-1RM12KT-F2-D2					
Lead <sup>a</sup>		0.0024	0.00050		mg/l	EPA 200.8

(a) Analysis performed at SGS Wheat Ridge, CO.

## Sample Results

## Report of Analysis

Report of Analysis

<b>Client Sample ID:</b>	RCK1-1RM2-F1-D1	<b>Date Sampled:</b>	06/26/20
<b>Lab Sample ID:</b>	LA64900-1	<b>Date Received:</b>	06/26/20
<b>Matrix:</b>	DW - Drinking Water	<b>Percent Solids:</b>	n/a
<b>Project:</b>	Drinking H2O Sampling at RCK, 3800 Eagle Street, New Orleans, LA		

Total Metals Analysis

Analyte	Result	MCL	RL	Units	DF	Prep	Analyzed By	Method	Prep Method
Lead <sup>a</sup>	0.00089	0.015	0.00050	mg/l	1	07/01/20	07/02/20 AMS	EPA 200.8 <sup>1</sup>	EPA 200.8 <sup>2</sup>

- (1) Instrument QC Batch: D:MA12821  
(2) Prep QC Batch: D:MP30663
- (a) Analysis performed at SGS Wheat Ridge, CO.

RL = Reporting Limit  
MCL = Maximum Contamination Level (40 CFR 141)

Report of Analysis

<b>Client Sample ID:</b>	RCK1-1RM2-F1-D2	<b>Date Sampled:</b>	06/26/20
<b>Lab Sample ID:</b>	LA64900-2	<b>Date Received:</b>	06/26/20
<b>Matrix:</b>	DW - Drinking Water	<b>Percent Solids:</b>	n/a
<b>Project:</b>	Drinking H2O Sampling at RCK, 3800 Eagle Street, New Orleans, LA		

Total Metals Analysis

Analyte	Result	MCL	RL	Units	DF	Prep	Analyzed By	Method	Prep Method
Lead <sup>a</sup>	0.0032	0.015	0.00050	mg/l	1	07/01/20	07/02/20 AMS	EPA 200.8 <sup>1</sup>	EPA 200.8 <sup>2</sup>

- (1) Instrument QC Batch: D:MA12821  
(2) Prep QC Batch: D:MP30663
- (a) Analysis performed at SGS Wheat Ridge, CO.

RL = Reporting Limit  
MCL = Maximum Contamination Level (40 CFR 141)

Report of Analysis

<b>Client Sample ID:</b>	RCK1-1RM2BA1-F1-D1	<b>Date Sampled:</b>	06/26/20
<b>Lab Sample ID:</b>	LA64900-3	<b>Date Received:</b>	06/26/20
<b>Matrix:</b>	DW - Drinking Water	<b>Percent Solids:</b>	n/a
<b>Project:</b>	Drinking H2O Sampling at RCK, 3800 Eagle Street, New Orleans, LA		

Total Metals Analysis

Analyte	Result	MCL	RL	Units	DF	Prep	Analyzed By	Method	Prep Method
Lead <sup>a</sup>	0.0015	0.015	0.00050	mg/l	1	07/01/20	07/02/20 AMS	EPA 200.8 <sup>1</sup>	EPA 200.8 <sup>2</sup>

- (1) Instrument QC Batch: D:MA12821  
(2) Prep QC Batch: D:MP30663
- (a) Analysis performed at SGS Wheat Ridge, CO.

RL = Reporting Limit  
MCL = Maximum Contamination Level (40 CFR 141)

Report of Analysis

<b>Client Sample ID:</b>	RCK1-1RM2BA1-F1-D2	<b>Date Sampled:</b>	06/26/20
<b>Lab Sample ID:</b>	LA64900-4	<b>Date Received:</b>	06/26/20
<b>Matrix:</b>	DW - Drinking Water	<b>Percent Solids:</b>	n/a
<b>Project:</b>	Drinking H2O Sampling at RCK, 3800 Eagle Street, New Orleans, LA		

Total Metals Analysis

Analyte	Result	MCL	RL	Units	DF	Prep	Analyzed By	Method	Prep Method
Lead <sup>a</sup>	0.0029	0.015	0.00050	mg/l	1	07/01/20	07/02/20 AMS	EPA 200.8 <sup>1</sup>	EPA 200.8 <sup>2</sup>

- (1) Instrument QC Batch: D:MA12821  
(2) Prep QC Batch: D:MP30663
- (a) Analysis performed at SGS Wheat Ridge, CO.

RL = Reporting Limit  
MCL = Maximum Contamination Level (40 CFR 141)

Report of Analysis

<b>Client Sample ID:</b>	RCK1-1RM3-WC1-D1	<b>Date Sampled:</b>	06/26/20
<b>Lab Sample ID:</b>	LA64900-5	<b>Date Received:</b>	06/26/20
<b>Matrix:</b>	DW - Drinking Water	<b>Percent Solids:</b>	n/a
<b>Project:</b>	Drinking H2O Sampling at RCK, 3800 Eagle Street, New Orleans, LA		

Total Metals Analysis

Analyte	Result	MCL	RL	Units	DF	Prep	Analyzed By	Method	Prep Method
Lead <sup>a</sup>	0.0019	0.015	0.00050	mg/l	1	07/01/20	07/02/20 AMS	EPA 200.8 <sup>1</sup>	EPA 200.8 <sup>2</sup>

- (1) Instrument QC Batch: D:MA12821  
(2) Prep QC Batch: D:MP30652
- (a) Analysis performed at SGS Wheat Ridge, CO.

RL = Reporting Limit  
MCL = Maximum Contamination Level (40 CFR 141)

Report of Analysis

<b>Client Sample ID:</b>	RCK1-1RM3-WC1-D2	<b>Date Sampled:</b>	06/26/20
<b>Lab Sample ID:</b>	LA64900-6	<b>Date Received:</b>	06/26/20
<b>Matrix:</b>	DW - Drinking Water	<b>Percent Solids:</b>	n/a
<b>Project:</b>	Drinking H2O Sampling at RCK, 3800 Eagle Street, New Orleans, LA		

Total Metals Analysis

Analyte	Result	MCL	RL	Units	DF	Prep	Analyzed By	Method	Prep Method
Lead <sup>a</sup>	0.0015	0.015	0.00050	mg/l	1	07/01/20	07/02/20 AMS	EPA 200.8 <sup>1</sup>	EPA 200.8 <sup>2</sup>

- (1) Instrument QC Batch: D:MA12821  
(2) Prep QC Batch: D:MP30663
- (a) Analysis performed at SGS Wheat Ridge, CO.

RL = Reporting Limit  
MCL = Maximum Contamination Level (40 CFR 141)

Report of Analysis

<b>Client Sample ID:</b>	RCK1-1RM3-F1-D1	<b>Date Sampled:</b>	06/26/20
<b>Lab Sample ID:</b>	LA64900-7	<b>Date Received:</b>	06/26/20
<b>Matrix:</b>	DW - Drinking Water	<b>Percent Solids:</b>	n/a
<b>Project:</b>	Drinking H2O Sampling at RCK, 3800 Eagle Street, New Orleans, LA		

Total Metals Analysis

Analyte	Result	MCL	RL	Units	DF	Prep	Analyzed By	Method	Prep Method
Lead <sup>a</sup>	0.013	0.015	0.00050	mg/l	1	07/01/20	07/02/20 AMS	EPA 200.8 <sup>1</sup>	EPA 200.8 <sup>2</sup>

- (1) Instrument QC Batch: D:MA12821  
(2) Prep QC Batch: D:MP30652
- (a) Analysis performed at SGS Wheat Ridge, CO.

RL = Reporting Limit  
MCL = Maximum Contamination Level (40 CFR 141)

Report of Analysis

<b>Client Sample ID:</b>	RCK1-1RM3-F1-D2	<b>Date Sampled:</b>	06/26/20
<b>Lab Sample ID:</b>	LA64900-8	<b>Date Received:</b>	06/26/20
<b>Matrix:</b>	DW - Drinking Water	<b>Percent Solids:</b>	n/a
<b>Project:</b>	Drinking H2O Sampling at RCK, 3800 Eagle Street, New Orleans, LA		

Total Metals Analysis

Analyte	Result	MCL	RL	Units	DF	Prep	Analyzed By	Method	Prep Method
Lead <sup>a</sup>	0.0027	0.015	0.00050	mg/l	1	07/01/20	07/02/20 AMS	EPA 200.8 <sup>1</sup>	EPA 200.8 <sup>2</sup>

- (1) Instrument QC Batch: D:MA12821  
(2) Prep QC Batch: D:MP30663
- (a) Analysis performed at SGS Wheat Ridge, CO.

RL = Reporting Limit  
MCL = Maximum Contamination Level (40 CFR 141)

Report of Analysis

<b>Client Sample ID:</b>	RCK1-1RM5-F1-D1	<b>Date Sampled:</b>	06/26/20
<b>Lab Sample ID:</b>	LA64900-9	<b>Date Received:</b>	06/26/20
<b>Matrix:</b>	DW - Drinking Water	<b>Percent Solids:</b>	n/a
<b>Project:</b>	Drinking H2O Sampling at RCK, 3800 Eagle Street, New Orleans, LA		

Total Metals Analysis

Analyte	Result	MCL	RL	Units	DF	Prep	Analyzed By	Method	Prep Method
Lead <sup>a</sup>	0.0015	0.015	0.00050	mg/l	1	07/01/20	07/02/20 AMS	EPA 200.8 <sup>1</sup>	EPA 200.8 <sup>2</sup>

- (1) Instrument QC Batch: D:MA12821  
(2) Prep QC Batch: D:MP30663
- (a) Analysis performed at SGS Wheat Ridge, CO.

RL = Reporting Limit  
MCL = Maximum Contamination Level (40 CFR 141)

Report of Analysis

<b>Client Sample ID:</b>	RCK1-1RM5-F1-D2	<b>Date Sampled:</b>	06/26/20
<b>Lab Sample ID:</b>	LA64900-10	<b>Date Received:</b>	06/26/20
<b>Matrix:</b>	DW - Drinking Water	<b>Percent Solids:</b>	n/a
<b>Project:</b>	Drinking H2O Sampling at RCK, 3800 Eagle Street, New Orleans, LA		

Total Metals Analysis

Analyte	Result	MCL	RL	Units	DF	Prep	Analyzed By	Method	Prep Method
Lead <sup>a</sup>	0.0015	0.015	0.00050	mg/l	1	07/01/20	07/02/20 AMS	EPA 200.8 <sup>1</sup>	EPA 200.8 <sup>2</sup>

- (1) Instrument QC Batch: D:MA12821  
(2) Prep QC Batch: D:MP30663
- (a) Analysis performed at SGS Wheat Ridge, CO.

RL = Reporting Limit  
MCL = Maximum Contamination Level (40 CFR 141)

Report of Analysis

<b>Client Sample ID:</b>	RCK1-1RM5BA1-F1-D1	<b>Date Sampled:</b>	06/26/20
<b>Lab Sample ID:</b>	LA64900-11	<b>Date Received:</b>	06/26/20
<b>Matrix:</b>	DW - Drinking Water	<b>Percent Solids:</b>	n/a
<b>Project:</b>	Drinking H2O Sampling at RCK, 3800 Eagle Street, New Orleans, LA		

Total Metals Analysis

Analyte	Result	MCL	RL	Units	DF	Prep	Analyzed By	Method	Prep Method
Lead <sup>a</sup>	0.0051	0.015	0.00050	mg/l	1	07/01/20	07/02/20 AMS	EPA 200.8 <sup>1</sup>	EPA 200.8 <sup>2</sup>

- (1) Instrument QC Batch: D:MA12821  
(2) Prep QC Batch: D:MP30663
- (a) Analysis performed at SGS Wheat Ridge, CO.

RL = Reporting Limit  
MCL = Maximum Contamination Level (40 CFR 141)

Report of Analysis

<b>Client Sample ID:</b>	RCK1-1RM5BA1-F1-D2	<b>Date Sampled:</b>	06/26/20
<b>Lab Sample ID:</b>	LA64900-12	<b>Date Received:</b>	06/26/20
<b>Matrix:</b>	DW - Drinking Water	<b>Percent Solids:</b>	n/a
<b>Project:</b>	Drinking H2O Sampling at RCK, 3800 Eagle Street, New Orleans, LA		

Total Metals Analysis

Analyte	Result	MCL	RL	Units	DF	Prep	Analyzed By	Method	Prep Method
Lead <sup>a</sup>	0.0018	0.015	0.00050	mg/l	1	07/01/20	07/02/20 AMS	EPA 200.8 <sup>1</sup>	EPA 200.8 <sup>2</sup>

- (1) Instrument QC Batch: D:MA12821  
(2) Prep QC Batch: D:MP30663
- (a) Analysis performed at SGS Wheat Ridge, CO.

RL = Reporting Limit  
MCL = Maximum Contamination Level (40 CFR 141)

Report of Analysis

<b>Client Sample ID:</b>	RCK1-1RM6-F1-D1	<b>Date Sampled:</b>	06/26/20
<b>Lab Sample ID:</b>	LA64900-13	<b>Date Received:</b>	06/26/20
<b>Matrix:</b>	DW - Drinking Water	<b>Percent Solids:</b>	n/a
<b>Project:</b>	Drinking H2O Sampling at RCK, 3800 Eagle Street, New Orleans, LA		

Total Metals Analysis

Analyte	Result	MCL	RL	Units	DF	Prep	Analyzed By	Method	Prep Method
Lead <sup>a</sup>	0.0046	0.015	0.00050	mg/l	1	07/01/20	07/02/20 AMS	EPA 200.8 <sup>1</sup>	EPA 200.8 <sup>2</sup>

- (1) Instrument QC Batch: D:MA12821  
(2) Prep QC Batch: D:MP30664
- (a) Analysis performed at SGS Wheat Ridge, CO.

RL = Reporting Limit  
MCL = Maximum Contamination Level (40 CFR 141)

Report of Analysis

<b>Client Sample ID:</b>	RCK1-1RM6-F1-D2	<b>Date Sampled:</b>	06/26/20
<b>Lab Sample ID:</b>	LA64900-14	<b>Date Received:</b>	06/26/20
<b>Matrix:</b>	DW - Drinking Water	<b>Percent Solids:</b>	n/a
<b>Project:</b>	Drinking H2O Sampling at RCK, 3800 Eagle Street, New Orleans, LA		

Total Metals Analysis

Analyte	Result	MCL	RL	Units	DF	Prep	Analyzed By	Method	Prep Method
Lead <sup>a</sup>	0.0015	0.015	0.00050	mg/l	1	07/01/20	07/02/20 AMS	EPA 200.8 <sup>1</sup>	EPA 200.8 <sup>2</sup>

- (1) Instrument QC Batch: D:MA12821  
(2) Prep QC Batch: D:MP30664
- (a) Analysis performed at SGS Wheat Ridge, CO.

RL = Reporting Limit  
MCL = Maximum Contamination Level (40 CFR 141)

Report of Analysis

<b>Client Sample ID:</b>	RCK1-1RM6BA1-F1-D1	<b>Date Sampled:</b>	06/26/20
<b>Lab Sample ID:</b>	LA64900-15	<b>Date Received:</b>	06/26/20
<b>Matrix:</b>	DW - Drinking Water	<b>Percent Solids:</b>	n/a
<b>Project:</b>	Drinking H2O Sampling at RCK, 3800 Eagle Street, New Orleans, LA		

Total Metals Analysis

Analyte	Result	MCL	RL	Units	DF	Prep	Analyzed By	Method	Prep Method
Lead <sup>a</sup>	0.077	0.015	0.00050	mg/l	1	07/01/20	07/02/20 AMS	EPA 200.8 <sup>1</sup>	EPA 200.8 <sup>2</sup>

- (1) Instrument QC Batch: D:MA12821  
(2) Prep QC Batch: D:MP30652
- (a) Analysis performed at SGS Wheat Ridge, CO.

RL = Reporting Limit  
MCL = Maximum Contamination Level (40 CFR 141)

Report of Analysis

<b>Client Sample ID:</b>	RCK1-1RM6BA1-F1-D2	<b>Date Sampled:</b>	06/26/20
<b>Lab Sample ID:</b>	LA64900-16	<b>Date Received:</b>	06/26/20
<b>Matrix:</b>	DW - Drinking Water	<b>Percent Solids:</b>	n/a
<b>Project:</b>	Drinking H2O Sampling at RCK, 3800 Eagle Street, New Orleans, LA		

Total Metals Analysis

Analyte	Result	MCL	RL	Units	DF	Prep	Analyzed By	Method	Prep Method
Lead <sup>a</sup>	0.0038	0.015	0.00050	mg/l	1	07/01/20	07/02/20 AMS	EPA 200.8 <sup>1</sup>	EPA 200.8 <sup>2</sup>

- (1) Instrument QC Batch: D:MA12821  
(2) Prep QC Batch: D:MP30664
- (a) Analysis performed at SGS Wheat Ridge, CO.

RL = Reporting Limit  
MCL = Maximum Contamination Level (40 CFR 141)

Report of Analysis

<b>Client Sample ID:</b>	RCK1-1RM7-F1-D1	<b>Date Sampled:</b>	06/26/20
<b>Lab Sample ID:</b>	LA64900-17	<b>Date Received:</b>	06/26/20
<b>Matrix:</b>	DW - Drinking Water	<b>Percent Solids:</b>	n/a
<b>Project:</b>	Drinking H2O Sampling at RCK, 3800 Eagle Street, New Orleans, LA		

Total Metals Analysis

Analyte	Result	MCL	RL	Units	DF	Prep	Analyzed By	Method	Prep Method
Lead <sup>a</sup>	0.0036	0.015	0.00050	mg/l	1	07/01/20	07/02/20 AMS	EPA 200.8 <sup>1</sup>	EPA 200.8 <sup>2</sup>

- (1) Instrument QC Batch: D:MA12821  
(2) Prep QC Batch: D:MP30652
- (a) Analysis performed at SGS Wheat Ridge, CO.

RL = Reporting Limit  
MCL = Maximum Contamination Level (40 CFR 141)

Report of Analysis

<b>Client Sample ID:</b>	RCK1-1RM7-F1-D2	<b>Date Sampled:</b>	06/26/20
<b>Lab Sample ID:</b>	LA64900-18	<b>Date Received:</b>	06/26/20
<b>Matrix:</b>	DW - Drinking Water	<b>Percent Solids:</b>	n/a
<b>Project:</b>	Drinking H2O Sampling at RCK, 3800 Eagle Street, New Orleans, LA		

Total Metals Analysis

Analyte	Result	MCL	RL	Units	DF	Prep	Analyzed By	Method	Prep Method
Lead <sup>a</sup>	0.00074	0.015	0.00050	mg/l	1	07/01/20	07/02/20 AMS	EPA 200.8 <sup>1</sup>	EPA 200.8 <sup>2</sup>

- (1) Instrument QC Batch: D:MA12821  
(2) Prep QC Batch: D:MP30664
- (a) Analysis performed at SGS Wheat Ridge, CO.

RL = Reporting Limit  
MCL = Maximum Contamination Level (40 CFR 141)

Report of Analysis

<b>Client Sample ID:</b>	RCK1-1RM8-F1-D1	<b>Date Sampled:</b>	06/26/20
<b>Lab Sample ID:</b>	LA64900-19	<b>Date Received:</b>	06/26/20
<b>Matrix:</b>	DW - Drinking Water	<b>Percent Solids:</b>	n/a
<b>Project:</b>	Drinking H2O Sampling at RCK, 3800 Eagle Street, New Orleans, LA		

Total Metals Analysis

Analyte	Result	MCL	RL	Units	DF	Prep	Analyzed By	Method	Prep Method
Lead <sup>a</sup>	0.021	0.015	0.00050	mg/l	1	07/01/20	07/02/20 AMS	EPA 200.8 <sup>1</sup>	EPA 200.8 <sup>2</sup>

- (1) Instrument QC Batch: D:MA12821  
(2) Prep QC Batch: D:MP30652
- (a) Analysis performed at SGS Wheat Ridge, CO.

RL = Reporting Limit  
MCL = Maximum Contamination Level (40 CFR 141)

Report of Analysis

<b>Client Sample ID:</b>	RCK1-1RM8-F1-D2	<b>Date Sampled:</b>	06/26/20
<b>Lab Sample ID:</b>	LA64900-20	<b>Date Received:</b>	06/26/20
<b>Matrix:</b>	DW - Drinking Water	<b>Percent Solids:</b>	n/a
<b>Project:</b>	Drinking H2O Sampling at RCK, 3800 Eagle Street, New Orleans, LA		

Total Metals Analysis

Analyte	Result	MCL	RL	Units	DF	Prep	Analyzed By	Method	Prep Method
Lead <sup>a</sup>	0.0035	0.015	0.00050	mg/l	1	07/01/20	07/02/20 AMS	EPA 200.8 <sup>1</sup>	EPA 200.8 <sup>2</sup>

- (1) Instrument QC Batch: D:MA12821  
(2) Prep QC Batch: D:MP30664
- (a) Analysis performed at SGS Wheat Ridge, CO.

RL = Reporting Limit  
MCL = Maximum Contamination Level (40 CFR 141)

Report of Analysis

<b>Client Sample ID:</b>	RCK1-1RM9-F1-D1	<b>Date Sampled:</b>	06/26/20
<b>Lab Sample ID:</b>	LA64900-21	<b>Date Received:</b>	06/26/20
<b>Matrix:</b>	DW - Drinking Water	<b>Percent Solids:</b>	n/a
<b>Project:</b>	Drinking H2O Sampling at RCK, 3800 Eagle Street, New Orleans, LA		

Total Metals Analysis

Analyte	Result	MCL	RL	Units	DF	Prep	Analyzed By	Method	Prep Method
Lead <sup>a</sup>	0.0011	0.015	0.00050	mg/l	1	07/01/20	07/02/20 AMS	EPA 200.8 <sup>1</sup>	EPA 200.8 <sup>2</sup>

- (1) Instrument QC Batch: D:MA12821  
(2) Prep QC Batch: D:MP30664
- (a) Analysis performed at SGS Wheat Ridge, CO.

RL = Reporting Limit  
MCL = Maximum Contamination Level (40 CFR 141)

Report of Analysis

<b>Client Sample ID:</b>	RCK1-1RM9-F1-D2	<b>Date Sampled:</b>	06/26/20
<b>Lab Sample ID:</b>	LA64900-22	<b>Date Received:</b>	06/26/20
<b>Matrix:</b>	DW - Drinking Water	<b>Percent Solids:</b>	n/a
<b>Project:</b>	Drinking H2O Sampling at RCK, 3800 Eagle Street, New Orleans, LA		

Total Metals Analysis

Analyte	Result	MCL	RL	Units	DF	Prep	Analyzed By	Method	Prep Method
Lead <sup>a</sup>	0.00070	0.015	0.00050	mg/l	1	07/01/20	07/02/20 AMS	EPA 200.8 <sup>1</sup>	EPA 200.8 <sup>2</sup>

- (1) Instrument QC Batch: D:MA12821  
(2) Prep QC Batch: D:MP30664
- (a) Analysis performed at SGS Wheat Ridge, CO.

RL = Reporting Limit  
MCL = Maximum Contamination Level (40 CFR 141)

Report of Analysis

<b>Client Sample ID:</b>	RCK1-1H3BA1-F1-D1	<b>Date Sampled:</b>	06/26/20
<b>Lab Sample ID:</b>	LA64900-23	<b>Date Received:</b>	06/26/20
<b>Matrix:</b>	DW - Drinking Water	<b>Percent Solids:</b>	n/a
<b>Project:</b>	Drinking H2O Sampling at RCK, 3800 Eagle Street, New Orleans, LA		

Total Metals Analysis

Analyte	Result	MCL	RL	Units	DF	Prep	Analyzed By	Method	Prep Method
Lead <sup>a</sup>	0.0023	0.015	0.00050	mg/l	1	07/01/20	07/02/20 AMS	EPA 200.8 <sup>1</sup>	EPA 200.8 <sup>2</sup>

- (1) Instrument QC Batch: D:MA12821  
(2) Prep QC Batch: D:MP30652
- (a) Analysis performed at SGS Wheat Ridge, CO.

RL = Reporting Limit  
MCL = Maximum Contamination Level (40 CFR 141)

Report of Analysis

<b>Client Sample ID:</b>	RCK1-1H3BA1-F1-D2	<b>Date Sampled:</b>	06/26/20
<b>Lab Sample ID:</b>	LA64900-24	<b>Date Received:</b>	06/26/20
<b>Matrix:</b>	DW - Drinking Water	<b>Percent Solids:</b>	n/a
<b>Project:</b>	Drinking H2O Sampling at RCK, 3800 Eagle Street, New Orleans, LA		

Total Metals Analysis

Analyte	Result	MCL	RL	Units	DF	Prep	Analyzed By	Method	Prep Method
Lead <sup>a</sup>	0.0057	0.015	0.00050	mg/l	1	07/01/20	07/02/20 AMS	EPA 200.8 <sup>1</sup>	EPA 200.8 <sup>2</sup>

- (1) Instrument QC Batch: D:MA12821  
(2) Prep QC Batch: D:MP30664
- (a) Analysis performed at SGS Wheat Ridge, CO.

RL = Reporting Limit  
MCL = Maximum Contamination Level (40 CFR 141)

Report of Analysis

<b>Client Sample ID:</b>	RCK1-1H2BA2-F1-D1	<b>Date Sampled:</b>	06/26/20
<b>Lab Sample ID:</b>	LA64900-25	<b>Date Received:</b>	06/26/20
<b>Matrix:</b>	DW - Drinking Water	<b>Percent Solids:</b>	n/a
<b>Project:</b>	Drinking H2O Sampling at RCK, 3800 Eagle Street, New Orleans, LA		

Total Metals Analysis

Analyte	Result	MCL	RL	Units	DF	Prep	Analyzed By	Method	Prep Method
Lead <sup>a</sup>	0.0088	0.015	0.00050	mg/l	1	07/01/20	07/02/20 AMS	EPA 200.8 <sup>1</sup>	EPA 200.8 <sup>2</sup>

- (1) Instrument QC Batch: D:MA12821  
(2) Prep QC Batch: D:MP30664
- (a) Analysis performed at SGS Wheat Ridge, CO.

RL = Reporting Limit  
MCL = Maximum Contamination Level (40 CFR 141)

Report of Analysis

<b>Client Sample ID:</b>	RCK1-1H2BA2-F1-D2	<b>Date Sampled:</b>	06/26/20
<b>Lab Sample ID:</b>	LA64900-26	<b>Date Received:</b>	06/26/20
<b>Matrix:</b>	DW - Drinking Water	<b>Percent Solids:</b>	n/a
<b>Project:</b>	Drinking H2O Sampling at RCK, 3800 Eagle Street, New Orleans, LA		

Total Metals Analysis

Analyte	Result	MCL	RL	Units	DF	Prep	Analyzed By	Method	Prep Method
Lead <sup>a</sup>	0.0021	0.015	0.00050	mg/l	1	07/01/20	07/02/20 AMS	EPA 200.8 <sup>1</sup>	EPA 200.8 <sup>2</sup>

- (1) Instrument QC Batch: D:MA12821  
(2) Prep QC Batch: D:MP30664
- (a) Analysis performed at SGS Wheat Ridge, CO.

RL = Reporting Limit  
MCL = Maximum Contamination Level (40 CFR 141)

Report of Analysis

<b>Client Sample ID:</b>	RCK1-1H1BA1-F1-D1	<b>Date Sampled:</b>	06/26/20
<b>Lab Sample ID:</b>	LA64900-27	<b>Date Received:</b>	06/26/20
<b>Matrix:</b>	DW - Drinking Water	<b>Percent Solids:</b>	n/a
<b>Project:</b>	Drinking H2O Sampling at RCK, 3800 Eagle Street, New Orleans, LA		

Total Metals Analysis

Analyte	Result	MCL	RL	Units	DF	Prep	Analyzed By	Method	Prep Method
Lead <sup>a</sup>	0.0012	0.015	0.00050	mg/l	1	07/01/20	07/02/20 AMS	EPA 200.8 <sup>1</sup>	EPA 200.8 <sup>2</sup>

- (1) Instrument QC Batch: D:MA12821  
(2) Prep QC Batch: D:MP30665
- (a) Analysis performed at SGS Wheat Ridge, CO.

RL = Reporting Limit  
MCL = Maximum Contamination Level (40 CFR 141)

Report of Analysis

<b>Client Sample ID:</b>	RCK1-1H1BA1-F1-D2	<b>Date Sampled:</b>	06/26/20
<b>Lab Sample ID:</b>	LA64900-28	<b>Date Received:</b>	06/26/20
<b>Matrix:</b>	DW - Drinking Water	<b>Percent Solids:</b>	n/a
<b>Project:</b>	Drinking H2O Sampling at RCK, 3800 Eagle Street, New Orleans, LA		

Total Metals Analysis

Analyte	Result	MCL	RL	Units	DF	Prep	Analyzed By	Method	Prep Method
Lead <sup>a</sup>	0.0038	0.015	0.00050	mg/l	1	07/01/20	07/02/20 AMS	EPA 200.8 <sup>1</sup>	EPA 200.8 <sup>2</sup>

- (1) Instrument QC Batch: D:MA12821  
(2) Prep QC Batch: D:MP30665
- (a) Analysis performed at SGS Wheat Ridge, CO.

RL = Reporting Limit  
MCL = Maximum Contamination Level (40 CFR 141)

Report of Analysis

<b>Client Sample ID:</b>	RCK1-1RM12KT-F1-D1	<b>Date Sampled:</b>	06/26/20
<b>Lab Sample ID:</b>	LA64900-29	<b>Date Received:</b>	06/26/20
<b>Matrix:</b>	DW - Drinking Water	<b>Percent Solids:</b>	n/a
<b>Project:</b>	Drinking H2O Sampling at RCK, 3800 Eagle Street, New Orleans, LA		

Total Metals Analysis

Analyte	Result	MCL	RL	Units	DF	Prep	Analyzed By	Method	Prep Method
Lead <sup>a</sup>	0.0016	0.015	0.00050	mg/l	1	07/01/20	07/02/20 AMS	EPA 200.8 <sup>1</sup>	EPA 200.8 <sup>2</sup>

- (1) Instrument QC Batch: D:MA12821  
(2) Prep QC Batch: D:MP30665  
(a) Analysis performed at SGS Wheat Ridge, CO.

RL = Reporting Limit  
MCL = Maximum Contamination Level (40 CFR 141)

Report of Analysis

<b>Client Sample ID:</b>	RCK1-1RM12KT-F1-D2	<b>Date Sampled:</b>	06/26/20
<b>Lab Sample ID:</b>	LA64900-30	<b>Date Received:</b>	06/26/20
<b>Matrix:</b>	DW - Drinking Water	<b>Percent Solids:</b>	n/a
<b>Project:</b>	Drinking H2O Sampling at RCK, 3800 Eagle Street, New Orleans, LA		

Total Metals Analysis

Analyte	Result	MCL	RL	Units	DF	Prep	Analyzed By	Method	Prep Method
Lead <sup>a</sup>	0.0028	0.015	0.00050	mg/l	1	07/01/20	07/02/20 AMS	EPA 200.8 <sup>1</sup>	EPA 200.8 <sup>2</sup>

- (1) Instrument QC Batch: D:MA12821  
(2) Prep QC Batch: D:MP30665
- (a) Analysis performed at SGS Wheat Ridge, CO.

RL = Reporting Limit  
MCL = Maximum Contamination Level (40 CFR 141)

Report of Analysis

<b>Client Sample ID:</b>	RCK1-1RM12KT-F2-D1	<b>Date Sampled:</b>	06/26/20
<b>Lab Sample ID:</b>	LA64900-31	<b>Date Received:</b>	06/26/20
<b>Matrix:</b>	DW - Drinking Water	<b>Percent Solids:</b>	n/a
<b>Project:</b>	Drinking H2O Sampling at RCK, 3800 Eagle Street, New Orleans, LA		

Total Metals Analysis

Analyte	Result	MCL	RL	Units	DF	Prep	Analyzed By	Method	Prep Method
Lead <sup>a</sup>	0.0011	0.015	0.00050	mg/l	1	07/01/20	07/02/20 AMS	EPA 200.8 <sup>1</sup>	EPA 200.8 <sup>2</sup>

- (1) Instrument QC Batch: D:MA12821  
(2) Prep QC Batch: D:MP30665
- (a) Analysis performed at SGS Wheat Ridge, CO.

RL = Reporting Limit  
MCL = Maximum Contamination Level (40 CFR 141)

Report of Analysis

<b>Client Sample ID:</b>	RCK1-1RM12KT-F2-D2	<b>Date Sampled:</b>	06/26/20
<b>Lab Sample ID:</b>	LA64900-32	<b>Date Received:</b>	06/26/20
<b>Matrix:</b>	DW - Drinking Water	<b>Percent Solids:</b>	n/a
<b>Project:</b>	Drinking H2O Sampling at RCK, 3800 Eagle Street, New Orleans, LA		

Total Metals Analysis

Analyte	Result	MCL	RL	Units	DF	Prep	Analyzed By	Method	Prep Method
Lead <sup>a</sup>	0.0024	0.015	0.00050	mg/l	1	07/01/20	07/02/20 AMS	EPA 200.8 <sup>1</sup>	EPA 200.8 <sup>2</sup>

- (1) Instrument QC Batch: D:MA12821  
(2) Prep QC Batch: D:MP30665
- (a) Analysis performed at SGS Wheat Ridge, CO.

RL = Reporting Limit  
MCL = Maximum Contamination Level (40 CFR 141)

## Misc. Forms

### Custody Documents and Other Forms

---

Includes the following where applicable:

- Chain of Custody

**SGS North America Inc. - Scott**  
500 Ambassador Caffery Parkway, Scott, LA 70583  
TEL: 337.237.4775 FAX: 337.237.7838  
[www.sgs.com/ehsusa](http://www.sgs.com/ehsusa)

[illegible]

<http://www.sps.org/en/terms-and-conditions>

Form of EHS-06-0028-00-FORM-Spot - Standard CUC-FINAL

## LA64900: Chain of Custody

Page 1 of 8

**SGS North America Inc. - Scott**  
500 Ambassador Caffery Parkway, Scott, LA 70583  
TEL: 337.237.4775 FAX: 337.237.7038  
[www.sgs.com/enhsus](http://www.sgs.com/enhsus)

[illegible]

Copy of EISA-QAC-0326-00-FORM-5000 - SIGNATURE COPY-FINAL

<http://www.sqs.com/en/terms-and-conditions>

## LA64900: Chain of Custody

Page 2 of 8

SGS North America Inc. • Scott  
500 Ambassador Caffery Parkway, Scott, LA 70583  
TEL: 337.237.4775 FAX: 337.237.7638  
[www.sgs.com/ehsusa](http://www.sgs.com/ehsusa)

[illegible]

Case of EHEC OAC-0026-00-FORM-Scott - Standard COC-FINAL

<http://www.sgs.com/en/terms-and-conditions>

## LA64900: Chain of Custody

Page 3 of 8

**SGS North America Inc. - Scull**  
500 Ambassador Caffery Parkway, Scott, LA 70563  
TEL: 337.237.4775 FAX: 337.237.7638  
[www.sgs.com/ehusa](http://www.sgs.com/ehusa)

		<b>SGS North America Inc. - Scott</b> 350 Ambassador Caffery Parkway, Scott LA 70583 TEL 337.237.4775 FAX: 337.237.7838 www.sgs.com/eusa		FED EX Tracking # _____ SGS Order # _____	Meta-Link Control # _____ SGS Job # <b>LA 64900</b>																				
		<b>Project Information</b>		Requester Analysis / See TEST CODE sheet Matrix Codes																					
Company Name <b>mmg, Inc.</b>		Project Name  		<div style="border: 1px solid black; padding: 5px; margin-bottom: 10px;"> <b>LEAD IN DRINKING WATER</b> </div> <div style="border: 1px solid black; padding: 5px;"> <b>LAB USE ONLY</b>  <div style="float: right; text-align: right;"> <b>6/26/20</b>  <b>7/1</b>  <b>1</b>  <b>1</b>  <b>01</b> </div> </div>																					
Street Address  		Street  																							
City State Zip  		City State Zip  																							
Project Contact  		Project # <b>39.21 LPH 110</b>  																							
Phone #  		Client Purchase Order #  																							
Sample(s) Name(s)  		Project Manager  		Address  																					
Field ID / Point of Collection  		Comp/Cont  		Date  		Time  		Scripted By  		Matrix  		# of Samples  		Number of processed bottles T1 T2 T3 T4 T5 T6 T7 T8 T9 T10 T11 T12 T13 T14 T15 T16 T17 T18 T19 T20 T21 T22 T23 T24 T25 T26 T27 T28 T29 T30 T31 T32 T33 T34 T35 T36 T37 T38 T39 T40 T41 T42 T43 T44 T45 T46 T47 T48 T49 T50 T51 T52 T53 T54 T55 T56 T57 T58 T59 T60 T61 T62 T63 T64 T65 T66 T67 T68 T69 T70 T71 T72 T73 T74 T75 T76 T77 T78 T79 T80 T81 T82 T83 T84 T85 T86 T87 T88 T89 T90 T91 T92 T93 T94 T95 T96 T97 T98 T99 T100											
Turnaround Time (Business days)  		Approved By (SGS PM) / Date  		Data Deliverable Information  		Comments / Special Instructions  																			
<input checked="" type="checkbox"/> Standard 10 Business Days <input type="checkbox"/> 5 Business Days RUSH <input type="checkbox"/> 4 Business Days RUSH <input type="checkbox"/> 3 Business Days RUSH <input type="checkbox"/> 2 Business Days RUSH <input type="checkbox"/> 1 Business Day EMERGENCY <input type="checkbox"/> Other		<input type="checkbox"/> Commercial "A" (Level 1) <input type="checkbox"/> Commercial "B" (Level 2) <input type="checkbox"/> FULLT1 (Level 3-4) <input type="checkbox"/> REDT1 (Level 5-6) <input type="checkbox"/> Commercial "C" Commercial "A" = Results Only. Commercial "B" = Results + CC Summary Commercial "C" = Results + CC Summary + Field Use Data		<input type="checkbox"/> TRRP <input type="checkbox"/> RECAP <input type="checkbox"/> State Forms <input type="checkbox"/> EDD Format <input type="checkbox"/> Other		Note: Sample inventory is verified upon receipt in the Laboratory <div style="border: 1px solid black; border-radius: 50%; width: 60px; height: 60px; text-align: center; line-height: 60px; margin: 10px auto;">OL</div> Received at Baton Rouge Service Center																			
Refrigerated by Carrier: 1 <b>John Lecomte</b> 2 <b>John Lecomte</b> 3 <b>John Lecomte</b> 4 <b>John Lecomte</b> 5 <b>John Lecomte</b>		Date / Time Day: <b>6/26/20</b> Time: <b>15:50</b> Date / Time  		Date / Time Day: <b>6/26/20</b> Time: <b>15:50</b> Date / Time  		Date / Time Day: <b>6/26/20</b> Time: <b>15:50</b> Date / Time  																			

Copy of EHS4-CAC-0028-00-FORM-Staff - Standard OOC-FINAL

<http://www.egs.com/en/terms-and-conditions>

## LA64900: Chain of Custody

Page 4 of 8

## SGS Sample Receipt Summary

**Job Number:** LA64900

**Client:** MMG INC.

**Project:** DRINKING H2O

**Date / Time Received:** 6/26/2020 3:50:00 PM

**Delivery Method:** Accutest Courier

**Airbill #s:**

**Cooler Temps:** #1: (1.8/1.8); DV441

### Cooler Security

Y or N

- |                           |                          |                                     |                       |                                     |                                     |
|---------------------------|--------------------------|-------------------------------------|-----------------------|-------------------------------------|-------------------------------------|
| 1. Custody Seals Present: | <input type="checkbox"/> | <input checked="" type="checkbox"/> | 3. COC Present:       | <input checked="" type="checkbox"/> | <input type="checkbox"/>            |
| 2. Custody Seals Intact:  | <input type="checkbox"/> | <input checked="" type="checkbox"/> | 4. Smpl Dates/Time OK | <input type="checkbox"/>            | <input checked="" type="checkbox"/> |

### Cooler Temperature

Y or N

- |                              |                                     |                          |
|------------------------------|-------------------------------------|--------------------------|
| 1. Temp criteria achieved:   | <input checked="" type="checkbox"/> | <input type="checkbox"/> |
| 2. Cooler temp verification: | IR Gun                              |                          |
| 3. Cooler media:             | Ice (direct contact)                |                          |
| 4. No. Coolers:              | 1                                   |                          |

### Quality Control Preservation

Y or N

N/A

- |                                 |                                     |                          |                                     |
|---------------------------------|-------------------------------------|--------------------------|-------------------------------------|
| 1. Trip Blank present / cooler: | <input type="checkbox"/>            | <input type="checkbox"/> | <input checked="" type="checkbox"/> |
| 2. Trip Blank listed on COC:    | <input type="checkbox"/>            | <input type="checkbox"/> | <input checked="" type="checkbox"/> |
| 3. Samples preserved properly:  | <input checked="" type="checkbox"/> | <input type="checkbox"/> |                                     |
| 4. VOCs headspace free:         | <input type="checkbox"/>            | <input type="checkbox"/> | <input checked="" type="checkbox"/> |

### Sample Integrity - Documentation

Y or N

- |  |                                     |                          |
|--|-------------------------------------|--------------------------|
| 1. Sample labels present on bottles:   | <input checked="" type="checkbox"/> | <input type="checkbox"/> |
| 2. Container labeling complete:        | <input checked="" type="checkbox"/> | <input type="checkbox"/> |
| 3. Sample container label / COC agree: | <input checked="" type="checkbox"/> | <input type="checkbox"/> |

### Sample Integrity - Condition

Y or N

- |                                  |                                     |                                     |
|----------------------------------|-------------------------------------|-------------------------------------|
| 1. Sample recvd within HT:       | <input checked="" type="checkbox"/> | <input type="checkbox"/>            |
| 2. All containers accounted for: | <input type="checkbox"/>            | <input checked="" type="checkbox"/> |
| 3. Condition of sample:          | Intact                              |                                     |

### Sample Integrity - Instructions

Y or N N/A

- |   |                                     |                                     |                                     |
|---|-------------------------------------|-------------------------------------|-------------------------------------|
| 1. Analysis requested is clear:           | <input checked="" type="checkbox"/> | <input type="checkbox"/>            |                                     |
| 2. Bottles received for unspecified tests | <input type="checkbox"/>            | <input checked="" type="checkbox"/> |                                     |
| 3. Sufficient volume recvd for analysis:  | <input checked="" type="checkbox"/> | <input type="checkbox"/>            |                                     |
| 4. Compositing instructions clear:        | <input type="checkbox"/>            | <input type="checkbox"/>            | <input checked="" type="checkbox"/> |
| 5. Filtering instructions clear:          | <input type="checkbox"/>            | <input type="checkbox"/>            | <input checked="" type="checkbox"/> |

Comments

No collection time on coc or sample containers.  
Received 2 sample containers for 1h1ba1-f1-d2  
Didn't receive sample ids rm2-wc1-d1, rm2-wc1-d2 and 1rm12kt-f2-d2

Responded to by: Amy Jackson

Response Date: 6/29/2020

Collection times were submitted via email and updated in LIMS. Use the sample ID written on the container for RCK-1rm12kt-f2-d2. RM2-WC1-D1 and RM2-WC1-D2 were not sampled and were listed on the COC in error.

**LA64900: Chain of Custody**

**Page 5 of 8**

MMG Job #:	3921 LDH 16		Date:	6/26/2020		2nd Draw Flush Sample Instructions		
Name of Facility:	Royal Castle Child Development Center			School ID = RCK		Faucets, Bubblers: 30 second flush		
Address of Facility:	3800 Eagle Street, NOLA 70118					Water Coolers: 15 minute flush		
Sample ID Key: (School ID)-(Floor #)(location code)-(fixture)(position)-(D1 or D2)								
Floor	Sample ID	Sample Type	Time	Fixture Type	Fixture Add-Ons	Location Description	Photo	Notes
1	RCK1-1Rm2-F1-D1	First Draw	6:06	<input checked="" type="radio"/> Faucet <input type="radio"/> Bubbler <input type="radio"/> Water Cooler <input type="radio"/> Other	<input type="radio"/> Filter <input type="radio"/> Aerator <input type="radio"/> Screen <input type="radio"/> Other	Room 2; C-Side Wall	Check <input checked="" type="checkbox"/>	
	RCK1-1Rm2-F1-D2	Flush (30 sec)	6:22	<input type="radio"/> Faucet <input type="radio"/> Bubbler <input type="radio"/> Water Cooler <input type="radio"/> Other	<input type="radio"/> Filter <input type="radio"/> Aerator <input type="radio"/> Screen <input type="radio"/> Other		Check <input type="checkbox"/>	
1	RCK1-1Rm2-WC1-D1	First Draw		<input type="radio"/> Faucet <input type="radio"/> Bubbler <input type="radio"/> Water Cooler <input type="radio"/> Other	<input type="radio"/> Filter <input type="radio"/> Aerator <input type="radio"/> Screen <input type="radio"/> Other	Room 2; C-Side Wall	Check <input type="checkbox"/>	Fixture Removed! - no sample collected
	RCK1-1Rm2-WC1-D2	Flush (15 MIN)		<input type="radio"/> Faucet <input type="radio"/> Bubbler <input type="radio"/> Water Cooler <input type="radio"/> Other	<input type="radio"/> Filter <input type="radio"/> Aerator <input type="radio"/> Screen <input type="radio"/> Other		Check <input type="checkbox"/>	
1	RCK1-1Rm2BA1-F1-D1	First Draw	6:08	<input checked="" type="radio"/> Faucet <input type="radio"/> Bubbler <input type="radio"/> Water Cooler <input type="radio"/> Other	<input type="radio"/> Filter <input type="radio"/> Aerator <input type="radio"/> Screen <input type="radio"/> Other	Room 2 - Attached Bathroom; B-Side Wall	Check <input checked="" type="checkbox"/>	
	RCK1-1Rm2BA1-F1-D2	Flush (30 sec)	6:24	<input type="radio"/> Faucet <input type="radio"/> Bubbler <input type="radio"/> Water Cooler <input type="radio"/> Other	<input type="radio"/> Filter <input type="radio"/> Aerator <input type="radio"/> Screen <input type="radio"/> Other		Check <input checked="" type="checkbox"/>	
1	RCK1-1Rm3-WC1-D1	First Draw	6:09	<input type="radio"/> Faucet <input type="radio"/> Bubbler <input checked="" type="radio"/> Water Cooler <input type="radio"/> Other	<input type="radio"/> Filter <input type="radio"/> Aerator <input type="radio"/> Screen <input type="radio"/> Other	Room 3 - Entry Area; C-Side Wall	Check <input checked="" type="checkbox"/>	
	RCK1-1Rm3-WC1-D2	Flush (15 MIN)	6:45	<input type="radio"/> Faucet <input type="radio"/> Bubbler <input type="radio"/> Water Cooler <input type="radio"/> Other	<input type="radio"/> Filter <input type="radio"/> Aerator <input type="radio"/> Screen <input type="radio"/> Other		Check <input checked="" type="checkbox"/>	
1	RCK1-1Rm3-F1-D1	First Draw	6:11	<input checked="" type="radio"/> Faucet <input type="radio"/> Bubbler <input type="radio"/> Water Cooler <input type="radio"/> Other	<input type="radio"/> Filter <input type="radio"/> Aerator <input type="radio"/> Screen <input type="radio"/> Other	Room 3 - Entry Area; C-Side Wall	Check <input checked="" type="checkbox"/>	
	RCK1-1Rm3-F1-D2	Flush (30 sec)	6:26	<input type="radio"/> Faucet <input type="radio"/> Bubbler <input type="radio"/> Water Cooler <input type="radio"/> Other	<input type="radio"/> Filter <input type="radio"/> Aerator <input type="radio"/> Screen <input type="radio"/> Other		Check <input checked="" type="checkbox"/>	
1	RCK1-1Rm5-F1-D1	First Draw	6:13	<input checked="" type="radio"/> Faucet <input type="radio"/> Bubbler <input type="radio"/> Water Cooler <input type="radio"/> Other	<input type="radio"/> Filter <input type="radio"/> Aerator <input type="radio"/> Screen <input type="radio"/> Other	Room 5; B-Side Wall	Check <input checked="" type="checkbox"/>	
	RCK1-1Rm5-F1-D2	Flush (30 sec)	6:27	<input type="radio"/> Faucet <input type="radio"/> Bubbler <input type="radio"/> Water Cooler <input type="radio"/> Other	<input type="radio"/> Filter <input type="radio"/> Aerator <input type="radio"/> Screen <input type="radio"/> Other		Check <input checked="" type="checkbox"/>	
1	RCK1-1Rm5BA1-F1-D1	First Draw	6:14	<input checked="" type="radio"/> Faucet <input type="radio"/> Bubbler <input type="radio"/> Water Cooler <input type="radio"/> Other	<input type="radio"/> Filter <input type="radio"/> Aerator <input type="radio"/> Screen <input type="radio"/> Other	Room 5 - Attached Bathroom; A-Side Wall	Check <input checked="" type="checkbox"/>	
	RCK1-1Rm5BA1-F1-D2	Flush	6:28	<input type="radio"/> Faucet <input type="radio"/> Bubbler <input type="radio"/> Water Cooler <input type="radio"/> Other	<input type="radio"/> Filter <input type="radio"/> Aerator <input type="radio"/> Screen <input type="radio"/> Other		Check <input checked="" type="checkbox"/>	
1	RCK1-1Rm6-F1-D1	First Draw	6:16	<input checked="" type="radio"/> Faucet <input type="radio"/> Bubbler <input type="radio"/> Water Cooler <input type="radio"/> Other	<input type="radio"/> Filter <input type="radio"/> Aerator <input type="radio"/> Screen <input type="radio"/> Other	Room 6; A-Side Wall	Check <input checked="" type="checkbox"/>	
	RCK1-1Rm6-F1-D2	Flush (30 sec)	6:30	<input type="radio"/> Faucet <input type="radio"/> Bubbler <input type="radio"/> Water Cooler <input type="radio"/> Other	<input type="radio"/> Filter <input type="radio"/> Aerator <input type="radio"/> Screen <input type="radio"/> Other		Check <input checked="" type="checkbox"/>	
1	RCK1-1Rm6BA1-F1-D1	First Draw	6:17	<input checked="" type="radio"/> Faucet <input type="radio"/> Bubbler <input type="radio"/> Water Cooler <input type="radio"/> Other	<input type="radio"/> Filter <input type="radio"/> Aerator <input type="radio"/> Screen <input type="radio"/> Other	Room 6 - Attached Bathroom; A-Side Wall	Check <input checked="" type="checkbox"/>	
	RCK1-1Rm6BA1-F1-D2	Flush (30 sec)	6:31	<input type="radio"/> Faucet <input type="radio"/> Bubbler <input type="radio"/> Water Cooler <input type="radio"/> Other	<input type="radio"/> Filter <input type="radio"/> Aerator <input type="radio"/> Screen <input type="radio"/> Other		Check <input checked="" type="checkbox"/>	

Page 1 of 3

LA64900: Chain of Custody

Page 6 of 8

MMG Job #:	3921 LDH 16		Date:	6/26/2020		2nd Draw Flush Sample Instructions		
Name of Facility:	Royal Castle Child Development Center		School ID = RCK		Faucets, Bubblers: 30 second flush			
Address of Facility:	3800 Eagle Street, NOLA 70118					Water Coolers: 15 minute flush		
Sample ID Key: (School ID)-(Floor #)-(location code)-(fixture)-(position)-(D1 or D2)								
Floor	Sample ID	Sample Type	Time	Fixture Type	Fixture Add-Ons	Location Description	Photo	Notes
1	RCK1-1Rm7-F1-D1	First Draw	6:18	<input checked="" type="radio"/> Faucet <input type="radio"/> Bubbler <input type="radio"/> Water Cooler <input type="radio"/> Other	<input type="radio"/> Filter <input type="radio"/> Aerator <input type="radio"/> Screen <input type="radio"/> Other	Room 7; A-Side Wall	Check <input checked="" type="checkbox"/>	
	RCK1-1Rm7-F1-D2	Flush (30 sec)	6:32					
1	RCK1-1Rm8-F1-D1	First Draw	6:14	<input checked="" type="radio"/> Faucet <input type="radio"/> Bubbler <input type="radio"/> Water Cooler <input type="radio"/> Other	<input type="radio"/> Filter <input type="radio"/> Aerator <input type="radio"/> Screen <input type="radio"/> Other	Room 8; C-Side Wall	Check <input type="checkbox"/>	
	RCK1-1Rm8-F1-D2	Flush (30 sec)	6:17					
1	RCK1-1Rm9-F1-D1	First Draw	6:13	<input checked="" type="radio"/> Faucet <input type="radio"/> Bubbler <input type="radio"/> Water Cooler <input type="radio"/> Other	<input type="radio"/> Filter <input type="radio"/> Aerator <input type="radio"/> Screen <input type="radio"/> Other	Room 9; A-Side Wall	Check <input type="checkbox"/>	
	RCK1-1Rm9-F1-D2	Flush (30 sec)	6:15					
1	RCK1-1Rm10-F1-D1	First Draw		<input type="radio"/> Faucet <input type="radio"/> Bubbler <input type="radio"/> Water Cooler <input type="radio"/> Other	<input type="radio"/> Filter <input type="radio"/> Aerator <input type="radio"/> Screen <input type="radio"/> Other	Room 10; C-Side Wall	Check <input type="checkbox"/>	Classroom inaccessible; no sample collected
	RCK1-1Rm10-F1-D2	Flush (30 sec)						
1	RCK1-1Rm11-F1-D1	First Draw		<input type="radio"/> Faucet <input type="radio"/> Bubbler <input type="radio"/> Water Cooler <input type="radio"/> Other	<input type="radio"/> Filter <input type="radio"/> Aerator <input type="radio"/> Screen <input type="radio"/> Other	Room 11; C-Side Wall	Check <input type="checkbox"/>	H V
	RCK1-1Rm11-F1-D2	Flush (30 sec)						
1	RCK1-1H3BA1-F1-D1	First Draw	6:07	<input checked="" type="radio"/> Faucet <input type="radio"/> Bubbler <input type="radio"/> Water Cooler <input type="radio"/> Other	<input type="radio"/> Filter <input type="radio"/> Aerator <input type="radio"/> Screen <input type="radio"/> Other	Hallway 3 - Boy's Bathroom; A-Side Wall	Check <input type="checkbox"/>	
	RCK1-1H3BA1-F1-D2	Flush (30 sec)	6:32					
1	RCK1-1H3BA2-F1-D1	First Draw	6:05	<input checked="" type="radio"/> Faucet <input type="radio"/> Bubbler <input type="radio"/> Water Cooler <input type="radio"/> Other	<input type="radio"/> Filter <input type="radio"/> Aerator <input type="radio"/> Screen <input type="radio"/> Other	Hallway 3 - Girl's Bathroom; B-Side Wall	Check <input type="checkbox"/>	
	RCK1-1H3BA2-F1-D2	Flush (30 sec)	6:30					
1	RCK1-1H1BA1-F1-D1	First Draw	6:10	<input checked="" type="radio"/> Faucet <input type="radio"/> Bubbler <input type="radio"/> Water Cooler <input type="radio"/> Other	<input type="radio"/> Filter <input type="radio"/> Aerator <input type="radio"/> Screen <input type="radio"/> Other	Hallway 1 - General Use Bathroom; C-Side Wall	Check <input type="checkbox"/>	
	RCK1-1H1BA1-F1-D2	Flush (30 sec)	6:34					
1	RCK1-1Rm12KT-F1-D1	First Draw	6:06	<input checked="" type="radio"/> Faucet <input type="radio"/> Bubbler <input type="radio"/> Water Cooler <input type="radio"/> Other	<input type="radio"/> Filter <input type="radio"/> Aerator <input type="radio"/> Screen <input type="radio"/> Other	Room 12 (Kitchen); C-Side Wall	Check <input type="checkbox"/>	
	RCK1-1Rm12KT-F1-D2	Flush (30 sec)	6:30					

Page 2 of 3

LA64900: Chain of Custody

Page 7 of 8

MMG Job #:	3921 LDH 16	Date:	6/26/2020	2nd Draw Flush Sample Instructions				
Name of Facility:	Royal Castle Child Development Center	School ID = RCK	Faucets, Bubblers: 30 second flush					
Address of Facility:	3800 Eagle Street, NOLA 70118			Water Coolers: 15 minute flush				
Sample ID Key: (School ID)-(Floor #)(location code)-(fixture)(position)-(D1 or D2)								
Floor	Sample ID	Sample Type	Time	Fixture Type	Fixture Add-Ons	Location Description	Photo	Notes
1	RCK1-1Rm12KT-F2-D1	First Draw	6:07	<input checked="" type="radio"/> Faucet <input type="radio"/> Bubbler <input type="radio"/> Water Cooler <input type="radio"/> Other	<input type="radio"/> Filter <input type="radio"/> Aerator <input type="radio"/> Screen <input type="radio"/> Other	Room 12 (Kitchen); C-Side Wall; Tri-basin sanitary sink	Check	
	RCK1-1Rm12KT-F2-D2	Flush (30 sec)	6:33	<input type="radio"/> Faucet <input type="radio"/> Bubbler <input type="radio"/> Water Cooler <input type="radio"/> Other	<input type="radio"/> Filter <input type="radio"/> Aerator <input type="radio"/> Screen <input type="radio"/> Other		<input type="radio"/>	
		First Draw		<input type="radio"/> Faucet <input type="radio"/> Bubbler <input type="radio"/> Water Cooler <input type="radio"/> Other	<input type="radio"/> Filter <input type="radio"/> Aerator <input type="radio"/> Screen <input type="radio"/> Other		Check	
		Flush		<input type="radio"/> Faucet <input type="radio"/> Bubbler <input type="radio"/> Water Cooler <input type="radio"/> Other	<input type="radio"/> Filter <input type="radio"/> Aerator <input type="radio"/> Screen <input type="radio"/> Other		<input type="radio"/>	
		First Draw		<input type="radio"/> Faucet <input type="radio"/> Bubbler <input type="radio"/> Water Cooler <input type="radio"/> Other	<input type="radio"/> Filter <input type="radio"/> Aerator <input type="radio"/> Screen <input type="radio"/> Other		Check	
		Flush		<input type="radio"/> Faucet <input type="radio"/> Bubbler <input type="radio"/> Water Cooler <input type="radio"/> Other	<input type="radio"/> Filter <input type="radio"/> Aerator <input type="radio"/> Screen <input type="radio"/> Other		<input type="radio"/>	
		First Draw		<input type="radio"/> Faucet <input type="radio"/> Bubbler <input type="radio"/> Water Cooler <input type="radio"/> Other	<input type="radio"/> Filter <input type="radio"/> Aerator <input type="radio"/> Screen <input type="radio"/> Other		Check	
		Flush		<input type="radio"/> Faucet <input type="radio"/> Bubbler <input type="radio"/> Water Cooler <input type="radio"/> Other	<input type="radio"/> Filter <input type="radio"/> Aerator <input type="radio"/> Screen <input type="radio"/> Other		<input type="radio"/>	
		First Draw		<input type="radio"/> Faucet <input type="radio"/> Bubbler <input type="radio"/> Water Cooler <input type="radio"/> Other	<input type="radio"/> Filter <input type="radio"/> Aerator <input type="radio"/> Screen <input type="radio"/> Other		Check	
		Flush		<input type="radio"/> Faucet <input type="radio"/> Bubbler <input type="radio"/> Water Cooler <input type="radio"/> Other	<input type="radio"/> Filter <input type="radio"/> Aerator <input type="radio"/> Screen <input type="radio"/> Other		<input type="radio"/>	
		First Draw		<input type="radio"/> Faucet <input type="radio"/> Bubbler <input type="radio"/> Water Cooler <input type="radio"/> Other	<input type="radio"/> Filter <input type="radio"/> Aerator <input type="radio"/> Screen <input type="radio"/> Other		Check	
		Flush		<input type="radio"/> Faucet <input type="radio"/> Bubbler <input type="radio"/> Water Cooler <input type="radio"/> Other	<input type="radio"/> Filter <input type="radio"/> Aerator <input type="radio"/> Screen <input type="radio"/> Other		<input type="radio"/>	

Page 3 of 3

LA64900: Chain of Custody

Page 8 of 8

## Misc. Forms

5

### Custody Documents and Other Forms

(SGS Wheat Ridge, CO)

---

Includes the following where applicable:

- Chain of Custody





## CHAIN OF CUSTODY

Page 2 of 3

500 Ambassador Caffery Parkway, Scott, LA 70583  
Phone: 800-304-3227 Fax: 337-237-7838

FED-EX Tracking #		Bottle Order Control #																																					
SGS Quote #		SGS Job #																																					
		LA64900																																					
Client / Reporting Information										Project Information										Requested Analysis ( see TEST CODE sheet)										Matrix Codes									
Company Name: <b>SGS North America Inc.</b>										Project Name: <b>Drinking H2O Sampling at RCK, 3800 Eagle Street, New Orleans, LA</b>																				DW - Drinking Water GW - Ground Water WW - Water SW - Surface Water SC - Soil SL - Sludge SED - Sediment OI - Oil LIQ - Other Liquid AIR - Air SOL - Other Solid WP - Wipe FB - Field Blank EB - Equipment Blank RB - Rinse Blank TB - Trip Blank									
Street Address: <b>500 Ambassador Caffery Parkway</b>										Street:																													
City State Zip: <b>Scott LA 70583</b>										Billing Information ( If different from Report to ) Company Name:																													
Project Contact: <b>amy.jackson2@sgs.com</b>										Project #																													
Phone #: <b>800-304-5227</b>										Client Purchase Order #																													
Sampler(s) Name(s): <b>EL</b>										Project Manager:										Attention:																			
Turnaround Time ( Business days )										Data Deliverable Information										Comments / Special Instructions																			
<input type="checkbox"/> Std. 10 Business Days <input type="checkbox"/> 5 Day RUSH <input type="checkbox"/> 3 Day EMERGENCY <input type="checkbox"/> 2 Day EMERGENCY <input type="checkbox"/> 1 Day EMERGENCY <input checked="" type="checkbox"/> other Due 7/6/2020 Emergency & Rush T/A data available via Lablink										Approved By (SGS PI): / Date: _____ _____ _____ _____ _____										<input type="checkbox"/> Commercial "A" ( Level 1 ) <input type="checkbox"/> Commercial "B" ( Level 2 ) <input type="checkbox"/> FULLT1 ( Level 3+4 ) <input type="checkbox"/> REDT1 ( Level 3+4 ) <input type="checkbox"/> Commercial "C" <input type="checkbox"/> TRRP <input type="checkbox"/> EDD Format <input type="checkbox"/> Other X COMMB Commercial "A" = Results Only Commercial "B" = Results + QC Summary																			
Relinquished by Sampler: <b>6/29/2020</b>										Received By: <b>1</b>										Relinquished By: <b>2</b>										Date Time: <b>7/2</b>									
Relinquished by Sampler: <b>3</b>										Received By: <b>3</b>										Relinquished By: <b>4</b>										Date Time: <b>7/2</b>									
Relinquished by: <b>5</b>										Received By: <b>5</b>										Custody Seal # <input checked="" type="checkbox"/> Intact <input type="checkbox"/> Not intact										Preserved where applicable <input checked="" type="checkbox"/> On Ice <input type="checkbox"/> Cooler Temp. <b>2.0</b>									

LA64900: Chain of Custody

Page 2 of 3





## CHAIN OF CUSTODY

Page 3 of 3

500 Ambassador Caffery Parkway, Scott, LA 70583  
Phone: 800-304-5227 Fax: 337-237-7838

FED-EX Tracking #		Bottle Order Control #																																					
SGS Quote #		SGS Job #																																					
		LA64900																																					
Client / Reporting Information										Project Information										Requested Analysis ( see TEST CODE sheet)										Matrix Codes									
Company Name: <b>SGS Accutest</b>										Project Name: Drinking H2O Sampling at RCK, 3800 Eagle Street, New Orleans, LA																				DW - Drinking Water GW - Ground Water WW - Water SW - Surface Water SO - Soil SL - Sludge SED - Sediment OI - Oil LIQ - Other Liquid AIR - Air SOL - Other Solid WP - Wipe FB - Field Blank EQ - Equipment Blank RB - Rinse Blank TB - Trip Blank									
Street Address: <b>500 Ambassador Caffery Parkway</b>										Street:																													
City State Zip <b>Scott LA 70583</b>										Billing Information ( if different from Report to ) Company Name																													
Project Contact E-mail <b>amy.jackson2@sgs.com</b>										Project #																													
Phone # <b>800-304-5227</b>										Client Purchase Order #																													
Sampler(s) Name(s) <b>EL</b>										Project Manager										Attention:																			
Turnaround Time ( Business days )										Data Deliverable Information										Comments / Special Instructions																			
<input type="checkbox"/> Std. 10 Business Days <input type="checkbox"/> 5 Day RUSH <input type="checkbox"/> 3 Day EMERGENCY <input type="checkbox"/> 2 Day EMERGENCY <input type="checkbox"/> 1 Day EMERGENCY <input checked="" type="checkbox"/> other Due 7/6/2020 Emergency & Rush T/A date available VIA Lablink										Approved By (SGS PM) / Date: _____ _____ _____ _____ _____										<input type="checkbox"/> Commercial "A" ( Level 1 ) <input type="checkbox"/> Commercial "B" ( Level 2 ) <input type="checkbox"/> FULLT1 ( Level 3+4 ) <input type="checkbox"/> REDT1 ( Level 3+4 ) <input type="checkbox"/> Commercial "C" Commercial "A" = Results Only Commercial "B" = Results + QC Summary <input type="checkbox"/> TRRP <input type="checkbox"/> EDD Format <input type="checkbox"/> Other X COMMB																			
Relinquished By: <b>1</b>										Received By: <b>1</b>										Relinquished By: <b>2</b>										Received By: <b>2</b>									
Relinquished by: <b>3</b>										Received By: <b>3</b>										Relinquished By: <b>4</b>										Received By: <b>4</b>									
Relinquished by: <b>5</b>										Received By: <b>5</b>										Custody Seal # <input type="checkbox"/> Intact <input type="checkbox"/> Not Intact										Preserved when applicable <input type="checkbox"/> On Ice Cooler Temp. <b>2.0</b>									

LA64900: Chain of Custody

Page 3 of 3



## Metals Analysis

### QC Data Summaries

(SGS Wheat Ridge, CO)

---

Includes the following where applicable:

- Method Blank Summaries
- Matrix Spike and Duplicate Summaries
- Blank Spike and Lab Control Sample Summaries
- Serial Dilution Summaries

BLANK RESULTS SUMMARY  
Part 2 - Method Blanks

Login Number: LA64900  
Account: ALLA - SGS Scott, LA  
Project: MMGLANO: Drinking H2O Sampling at RCK, 3800 Eagle Street, New Orleans, LA

QC Batch ID: MP30652  
Matrix Type: DRINKING WATER

Methods: EPA 200.8  
Units: mg/l

Prep Date: 07/01/20

Metal	RL	IDL	MDL	MB raw	final
Copper	0.0020	.00006	.00031		
Iron	0.010	.0035	.0098		
Lead	0.00050	.0000079	.00003	-0.000039	<0.00050

Associated samples MP30652: LA64900-5, LA64900-7, LA64900-15, LA64900-17, LA64900-19, LA64900-23

Results < IDL are shown as zero for calculation purposes  
(\*) Outside of QC limits  
(anr) Analyte not requested

MATRIX SPIKE AND DUPLICATE RESULTS SUMMARY

Login Number: LA64900

Account: ALLA - SGS Scott, LA

Project: MMGLANO: Drinking H2O Sampling at RCK, 3800 Eagle Street, New Orleans, LA

QC Batch ID: MP30652

Methods: EPA 200.8

Matrix Type: DRINKING WATER

Units: mg/l

Prep Date:

07/01/20

Metal	DA26978-12 Original MS	Spikelot ICPALL2	% Rec	QC Limits
-------	---------------------------	---------------------	-------	--------------

Copper

anr

Iron

Lead

0.0026

0.21

0.20

103.7

70-130

Associated samples MP30652: LA64900-5, LA64900-7, LA64900-15, LA64900-17, LA64900-19, LA64900-23

Results < IDL are shown as zero for calculation purposes

(\*) Outside of QC limits

(N) Matrix Spike Rec. outside of QC limits

(anr) Analyte not requested

MATRIX SPIKE AND DUPLICATE RESULTS SUMMARY

Login Number: LA64900

Account: ALLA - SGS Scott, LA

Project: MMGLANO: Drinking H2O Sampling at RCK, 3800 Eagle Street, New Orleans, LA

QC Batch ID: MP30652

Methods: EPA 200.8

Matrix Type: DRINKING WATER

Units: mg/l

Prep Date:

07/01/20

Metal	DA26978-12 Original MSD	Spikelot ICPALL2	% Rec	MSD RPD	QC Limit
-------	----------------------------	---------------------	-------	------------	-------------

Copper anr

Iron

Lead 0.0026 0.21 0.20 103.7 0.0 20

Associated samples MP30652: LA64900-5, LA64900-7, LA64900-15, LA64900-17, LA64900-19, LA64900-23

Results < IDL are shown as zero for calculation purposes

(\*) Outside of QC limits

(N) Matrix Spike Rec. outside of QC limits

(anr) Analyte not requested

SPIKE BLANK AND LAB CONTROL SAMPLE SUMMARY

Login Number: LA64900

Account: ALLA - SGS Scott, LA

Project: MMGLANO: Drinking H2O Sampling at RCK, 3800 Eagle Street, New Orleans, LA

QC Batch ID: MP30652

Methods: EPA 200.8

Matrix Type: DRINKING WATER

Units: mg/l

Prep Date: 07/01/20

Metal	BSP Result	Spikelot ICPALL2	% Rec	QC Limits
-------	---------------	---------------------	-------	--------------

Copper anr

Iron

Lead 0.21 0.20 105.0 85-115

Associated samples MP30652: LA64900-5, LA64900-7, LA64900-15, LA64900-17, LA64900-19, LA64900-23

Results < IDL are shown as zero for calculation purposes

(\*) Outside of QC limits

(anr) Analyte not requested

BLANK RESULTS SUMMARY  
Part 2 - Method Blanks

Login Number: LA64900  
Account: ALLA - SGS Scott, LA  
Project: MMGLANO: Drinking H2O Sampling at RCK, 3800 Eagle Street, New Orleans, LA

QC Batch ID: MP30663  
Matrix Type: DRINKING WATER

Methods: EPA 200.8  
Units: mg/l

Prep Date: 07/01/20

Metal	RL	IDL	MDL	MB raw	final
Copper	0.0020	.00006	.00031		
Iron	0.010	.0035	.0098		
Lead	0.00050	.0000079	.00003	-0.000034	<0.00050

Associated samples MP30663: LA64900-1, LA64900-2, LA64900-3, LA64900-4, LA64900-6, LA64900-8, LA64900-9, LA64900-10, LA64900-11, LA64900-12

Results < IDL are shown as zero for calculation purposes  
(\*) Outside of QC limits  
(anr) Analyte not requested

MATRIX SPIKE AND DUPLICATE RESULTS SUMMARY

Login Number: LA64900

Account: ALLA - SGS Scott, LA

Project: MMGLANO: Drinking H2O Sampling at RCK, 3800 Eagle Street, New Orleans, LA

QC Batch ID: MP30663

Methods: EPA 200.8

Matrix Type: DRINKING WATER

Units: mg/l

Prep Date:

07/01/20

Metal	LA64900-1 Original MS	Spikelot ICPALL2	% Rec	QC Limits
-------	--------------------------	---------------------	-------	--------------

Copper

Iron

Lead 0.00089 0.21 0.20 104.6 70-130

Associated samples MP30663: LA64900-1, LA64900-2, LA64900-3, LA64900-4, LA64900-6, LA64900-8, LA64900-9, LA64900-10, LA64900-11, LA64900-12

Results < IDL are shown as zero for calculation purposes

(\*) Outside of QC limits

(N) Matrix Spike Rec. outside of QC limits

(anr) Analyte not requested

MATRIX SPIKE AND DUPLICATE RESULTS SUMMARY

Login Number: LA64900

Account: ALLA - SGS Scott, LA

Project: MMGLANO: Drinking H2O Sampling at RCK, 3800 Eagle Street, New Orleans, LA

QC Batch ID: MP30663

Methods: EPA 200.8

Matrix Type: DRINKING WATER

Units: mg/l

Prep Date:

07/01/20

Metal	LA64900-1 Original MSD	Spikelot ICPALL2	% Rec	MSD RPD	QC Limit
-------	---------------------------	---------------------	-------	------------	-------------

Copper

Iron

Lead 0.00089 0.21 0.20 104.6 0.0 20

Associated samples MP30663: LA64900-1, LA64900-2, LA64900-3, LA64900-4, LA64900-6, LA64900-8, LA64900-9, LA64900-10, LA64900-11, LA64900-12

Results < IDL are shown as zero for calculation purposes

(\*) Outside of QC limits

(N) Matrix Spike Rec. outside of QC limits

(anr) Analyte not requested

SPIKE BLANK AND LAB CONTROL SAMPLE SUMMARY

Login Number: LA64900

Account: ALLA - SGS Scott, LA

Project: MMGLANO: Drinking H2O Sampling at RCK, 3800 Eagle Street, New Orleans, LA

QC Batch ID: MP30663

Methods: EPA 200.8

Matrix Type: DRINKING WATER

Units: mg/l

Prep Date: 07/01/20

Metal	BSP Result	Spikelot ICPALL2	% Rec	QC Limits
-------	---------------	---------------------	-------	--------------

Copper

Iron

Lead 0.20 0.20 100.0 85-115

Associated samples MP30663: LA64900-1, LA64900-2, LA64900-3, LA64900-4, LA64900-6, LA64900-8, LA64900-9, LA64900-10, LA64900-11, LA64900-12

Results < IDL are shown as zero for calculation purposes

(\*) Outside of QC limits

(anr) Analyte not requested

BLANK RESULTS SUMMARY  
Part 2 - Method Blanks

Login Number: LA64900  
Account: ALLA - SGS Scott, LA  
Project: MMGLANO: Drinking H2O Sampling at RCK, 3800 Eagle Street, New Orleans, LA

QC Batch ID: MP30664  
Matrix Type: DRINKING WATER

Methods: EPA 200.8  
Units: mg/l

Prep Date: 07/01/20

Metal	RL	IDL	MDL	MB raw	final
Copper	0.0020	.00006	.00031		
Iron	0.010	.0035	.0098		
Lead	0.00050	.0000079	.00003	-0.000037	<0.00050

Associated samples MP30664: LA64900-13, LA64900-14, LA64900-16, LA64900-18, LA64900-20, LA64900-21, LA64900-22, LA64900-24, LA64900-25, LA64900-26

Results < IDL are shown as zero for calculation purposes  
(\*) Outside of QC limits  
(anr) Analyte not requested

MATRIX SPIKE AND DUPLICATE RESULTS SUMMARY

Login Number: LA64900

Account: ALLA - SGS Scott, LA

Project: MMGLANO: Drinking H2O Sampling at RCK, 3800 Eagle Street, New Orleans, LA

QC Batch ID: MP30664

Methods: EPA 200.8

Matrix Type: DRINKING WATER

Units: mg/l

Prep Date:

07/01/20

Metal	LA64900-13 Original MS	Spikelot ICPALL2	% Rec	QC Limits
-------	---------------------------	---------------------	-------	--------------

Copper

Iron

Lead 0.0046 0.21 0.20 102.7 70-130

Associated samples MP30664: LA64900-13, LA64900-14, LA64900-16, LA64900-18, LA64900-20, LA64900-21, LA64900-22, LA64900-24, LA64900-25, LA64900-26

Results < IDL are shown as zero for calculation purposes

(\*) Outside of QC limits

(N) Matrix Spike Rec. outside of QC limits

(anr) Analyte not requested

MATRIX SPIKE AND DUPLICATE RESULTS SUMMARY

Login Number: LA64900

Account: ALLA - SGS Scott, LA

Project: MMGLANO: Drinking H2O Sampling at RCK, 3800 Eagle Street, New Orleans, LA

QC Batch ID: MP30664

Methods: EPA 200.8

Matrix Type: DRINKING WATER

Units: mg/l

Prep Date:

07/01/20

Metal	LA64900-13 Original MSD	Spikelot ICPALL2	% Rec	MSD RPD	QC Limit
-------	----------------------------	---------------------	-------	------------	-------------

Copper

Iron

Lead 0.0046 0.21 0.20 102.7 0.0 20

Associated samples MP30664: LA64900-13, LA64900-14, LA64900-16, LA64900-18, LA64900-20, LA64900-21, LA64900-22, LA64900-24, LA64900-25, LA64900-26

Results < IDL are shown as zero for calculation purposes

(\*) Outside of QC limits

(N) Matrix Spike Rec. outside of QC limits

(anr) Analyte not requested

SPIKE BLANK AND LAB CONTROL SAMPLE SUMMARY

Login Number: LA64900

Account: ALLA - SGS Scott, LA

Project: MMGLANO: Drinking H2O Sampling at RCK, 3800 Eagle Street, New Orleans, LA

QC Batch ID: MP30664

Methods: EPA 200.8

Matrix Type: DRINKING WATER

Units: mg/l

Prep Date: 07/01/20

Metal	BSP Result	Spikelot ICPALL2	% Rec	QC Limits
-------	---------------	---------------------	-------	--------------

Copper

Iron

Lead 0.20 0.20 100.0 85-115

Associated samples MP30664: LA64900-13, LA64900-14, LA64900-16, LA64900-18, LA64900-20, LA64900-21, LA64900-22, LA64900-24, LA64900-25, LA64900-26

Results < IDL are shown as zero for calculation purposes

(\*) Outside of QC limits

(anr) Analyte not requested

BLANK RESULTS SUMMARY  
Part 2 - Method Blanks

Login Number: LA64900  
Account: ALLA - SGS Scott, LA  
Project: MMGLANO: Drinking H2O Sampling at RCK, 3800 Eagle Street, New Orleans, LA

QC Batch ID: MP30665  
Matrix Type: DRINKING WATER

Methods: EPA 200.8  
Units: mg/l

Prep Date: 07/01/20

Metal	RL	IDL	MDL	MB raw	final
Copper	0.0020	.00006	.00031		
Iron	0.010	.0035	.0098		
Lead	0.00050	.0000079	.00003	-0.000041	<0.00050

Associated samples MP30665: LA64900-27, LA64900-28, LA64900-29, LA64900-30, LA64900-31, LA64900-32

Results < IDL are shown as zero for calculation purposes  
(\*) Outside of QC limits  
(anr) Analyte not requested

MATRIX SPIKE AND DUPLICATE RESULTS SUMMARY

Login Number: LA64900

Account: ALLA - SGS Scott, LA

Project: MMGLANO: Drinking H2O Sampling at RCK, 3800 Eagle Street, New Orleans, LA

QC Batch ID: MP30665

Methods: EPA 200.8

Matrix Type: DRINKING WATER

Units: mg/l

Prep Date:

07/01/20

Metal	LA64900-27 Original MS	Spikelot ICPALL2	% Rec	QC Limits
-------	---------------------------	---------------------	-------	--------------

Copper

Iron

Lead 0.0012 0.21 0.20 104.4 70-130

Associated samples MP30665: LA64900-27, LA64900-28, LA64900-29, LA64900-30, LA64900-31, LA64900-32

Results < IDL are shown as zero for calculation purposes

(\*) Outside of QC limits

(N) Matrix Spike Rec. outside of QC limits

(anr) Analyte not requested

MATRIX SPIKE AND DUPLICATE RESULTS SUMMARY

Login Number: LA64900

Account: ALLA - SGS Scott, LA

Project: MMGLANO: Drinking H2O Sampling at RCK, 3800 Eagle Street, New Orleans, LA

QC Batch ID: MP30665

Methods: EPA 200.8

Matrix Type: DRINKING WATER

Units: mg/l

Prep Date:

07/01/20

Metal	LA64900-27 Original MSD	Spikelot ICPALL2	% Rec	MSD RPD	QC Limit
-------	----------------------------	---------------------	-------	------------	-------------

Copper

Iron

Lead 0.0012 0.21 0.20 104.4 0.0 20

Associated samples MP30665: LA64900-27, LA64900-28, LA64900-29, LA64900-30, LA64900-31, LA64900-32

Results < IDL are shown as zero for calculation purposes

(\*) Outside of QC limits

(N) Matrix Spike Rec. outside of QC limits

(anr) Analyte not requested

SPIKE BLANK AND LAB CONTROL SAMPLE SUMMARY

Login Number: LA64900

Account: ALLA - SGS Scott, LA

Project: MMGLANO: Drinking H2O Sampling at RCK, 3800 Eagle Street, New Orleans, LA

QC Batch ID: MP30665

Methods: EPA 200.8

Matrix Type: DRINKING WATER

Units: mg/l

Prep Date: 07/01/20

Metal	BSP Result	Spikelot ICPALL2	% Rec	QC Limits
-------	---------------	---------------------	-------	--------------

Copper

Iron

Lead 0.20 0.20 100.0 85-115

Associated samples MP30665: LA64900-27, LA64900-28, LA64900-29, LA64900-30, LA64900-31, LA64900-32

Results < IDL are shown as zero for calculation purposes

(\*) Outside of QC limits

(anr) Analyte not requested

**Water Sampling Report (Sampling Date: 6/26/2020)**

**Royal Castle Child Development Center  
3800 Eagle Street, New Orleans, LA 70118**

**Report Date: 7/17/2020  
MMG # 3921 LDH 16**

**Appendix C: Laboratory Accreditations and  
Certifications**



# STATE OF LOUISIANA

DEPARTMENT OF HEALTH  
OFFICE OF PUBLIC HEALTH



## SGS NORTH AMERICA, INC. SCOTT

500 Ambassador Caffery Parkway

Scott, LA 70583

is accredited by the State of Louisiana in accordance with  
the 2009 TNI Standard and/or Department of Health regulations  
Louisiana Administrative Code 48:V.Chapter 80 and  
Louisiana Administrative Code 51:XII.101 and 301

Scope of accreditation is limited to the  
“TNI Accredited Fields of Testing”  
which accompany this certificate

Continued accredited status depends on successful  
ongoing participation in the program

CERTIFICATE NUMBER: LA025  
EFFECTIVE DATE: January 1, 2020  
EXPIRATION DATE: December 31, 2020

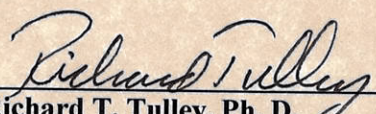
  
Richard T. Tulley, Ph. D.,  
Public Health Laboratory Director  
1209 Leesville Avenue  
Baton Rouge, Louisiana 70802

  
Grant Aucoin  
Laboratory Accreditation Program  
Manager

subject to forfeiture or revocation